

THIS DRAWING AND THE INFORMATION CONTAINED WITHIN IT ARE CONFIDENTIAL AND MAY NOT BE COPIED OR DISCLOSED WITHOUT THE WRITTEN PERMISSION OF LITTELFUSE.

REVISIONS				
REV.	CHANGE NO.	DESCRIPTION	DATE	APPROVED
A	520748	PRODUCTION RELEASE	05/29/2019	DGK

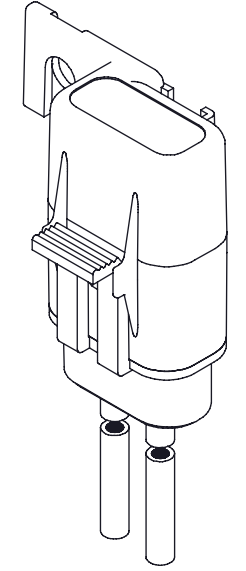
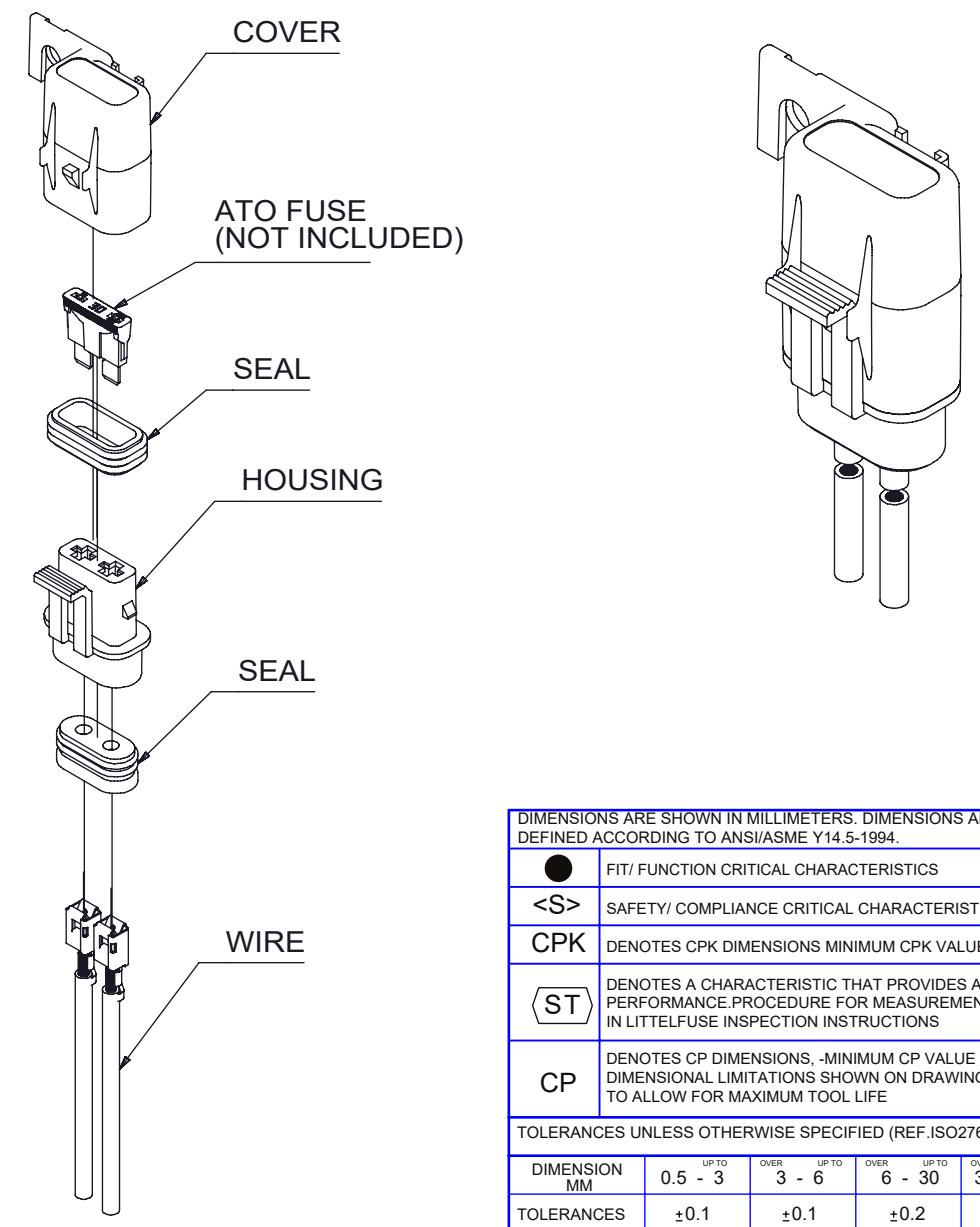
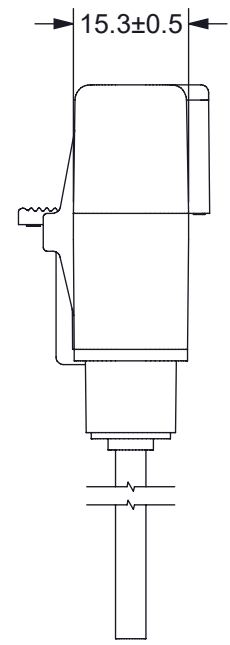
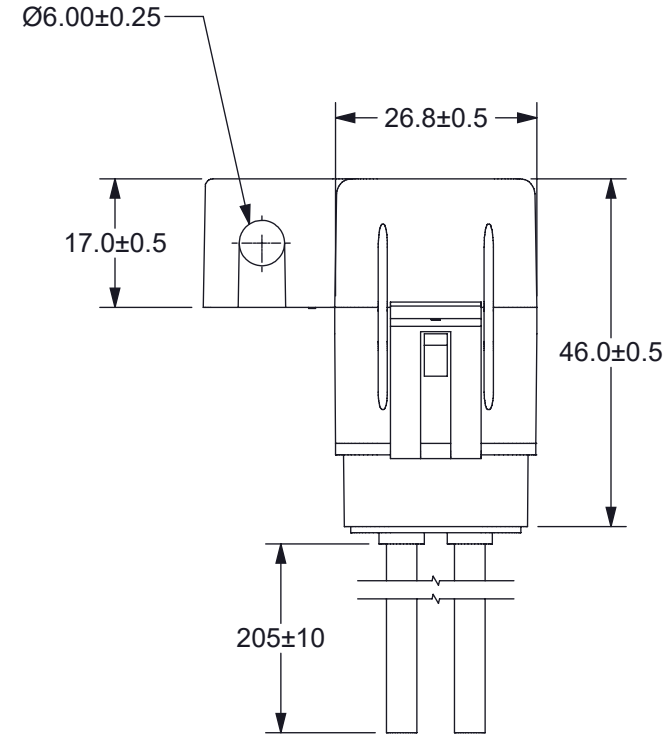
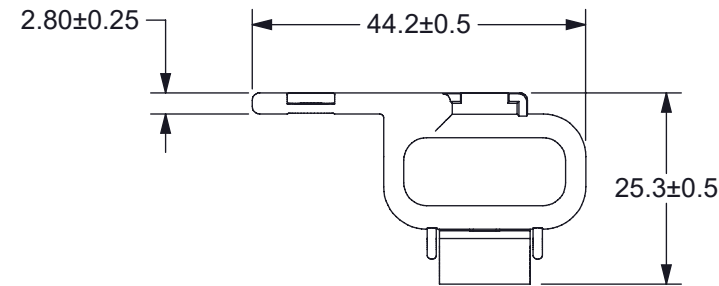

- NOTES:
- HOUSING AND COVER MATERIAL: BLACK PC
 - SEAL MATERIAL: SILICONE
 - WIRE: 12 AWG STRANDED COPPER, RED GXL WIRE, 125°C TEMPERATURE RATING
 - FOR USE WITH ISO 8820 TYPE 'C' FUSE (ATO FUSE).
 - RATING: 30A MAXIMUM, 32Vdc
 - FUSEHOLDER IS DUST TIGHT AND PROTECTED AGAINST IMMERSION, IP67 RATED.
 - FUSE IS NOT INCLUDED.
 - FUSEHOLDER IS RoHS COMPLIANT.

DIMENSIONS ARE SHOWN IN MILLIMETERS. DIMENSIONS AND TOLERANCES ARE DEFINED ACCORDING TO ANSI/ASME Y14.5-1994.

●	FIT/ FUNCTION CRITICAL CHARACTERISTICS
<S>	SAFETY/ COMPLIANCE CRITICAL CHARACTERISTICS SYMBOL
CPK	DENOTES CPK DIMENSIONS MINIMUM CPK VALUE
ST	DENOTES A CHARACTERISTIC THAT PROVIDES AN INDICATION OF PROCESS PERFORMANCE. PROCEDURE FOR MEASUREMENT AND TRACKING TO BE DEFINED IN LITTELFUSE INSPECTION INSTRUCTIONS
CP	DENOTES CP DIMENSIONS, -MINIMUM CP VALUE MUST BE WITHIN THE DIMENSIONAL LIMITATIONS SHOWN ON DRAWING AND INITIALLY LOCATED TO ALLOW FOR MAXIMUM TOOL LIFE

TOLERANCES UNLESS OTHERWISE SPECIFIED (REF. ISO2768-M) FOR METAL, REF. SPI PLASTICS

DIMENSION MM	0.5 - 3	3 - 6	6 - 30	30 - 120	120 - 400	ANGLE
TOLERANCES	±0.1	±0.1	±0.2	±0.3	±0.5	±0.5°

NAME	DATE
DRAWN DGK	05/29/2019
CHECKED MS	06/26/2019
-	-
-	-

FORM NO: CVP-PE40-0003 REV A

THIRD ANGLE PROJECTION

Littelfuse
Expertise Applied | Answers Delivered

TITLE
**FUSEHOLDER, IN-LINE ATO
12 AWG GXL, SEALED**

SIZE B	DWG. NO. OL-FHAS100	REV. A
--------	---------------------	--------

DO NOT SCALE DRAWING SCALE 2:1 SHEET 1 OF 1