

| REVISION | | |
|----------|----------|--|
| REV | DATE | DESCRIPTION |
| A | 6/25/18 | 519469GCP - RELEASE PER EM3026 MRY |
| B | 10/20/20 | 522884ECP/C - UPDATE TO NEW CAP DESIGN MRY |
| C | 3/31/22 | 524923ECP/D - ADD TOLERANCES MRY |

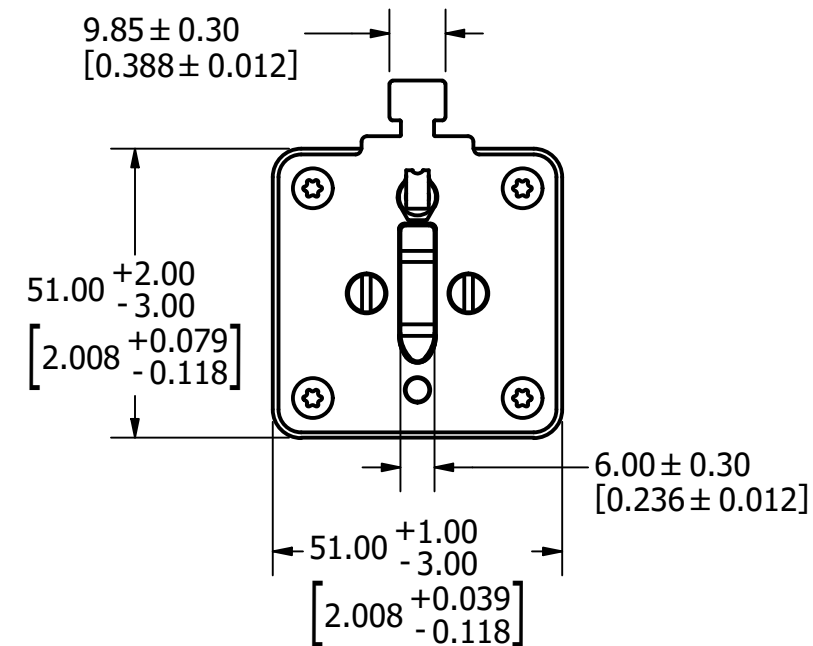
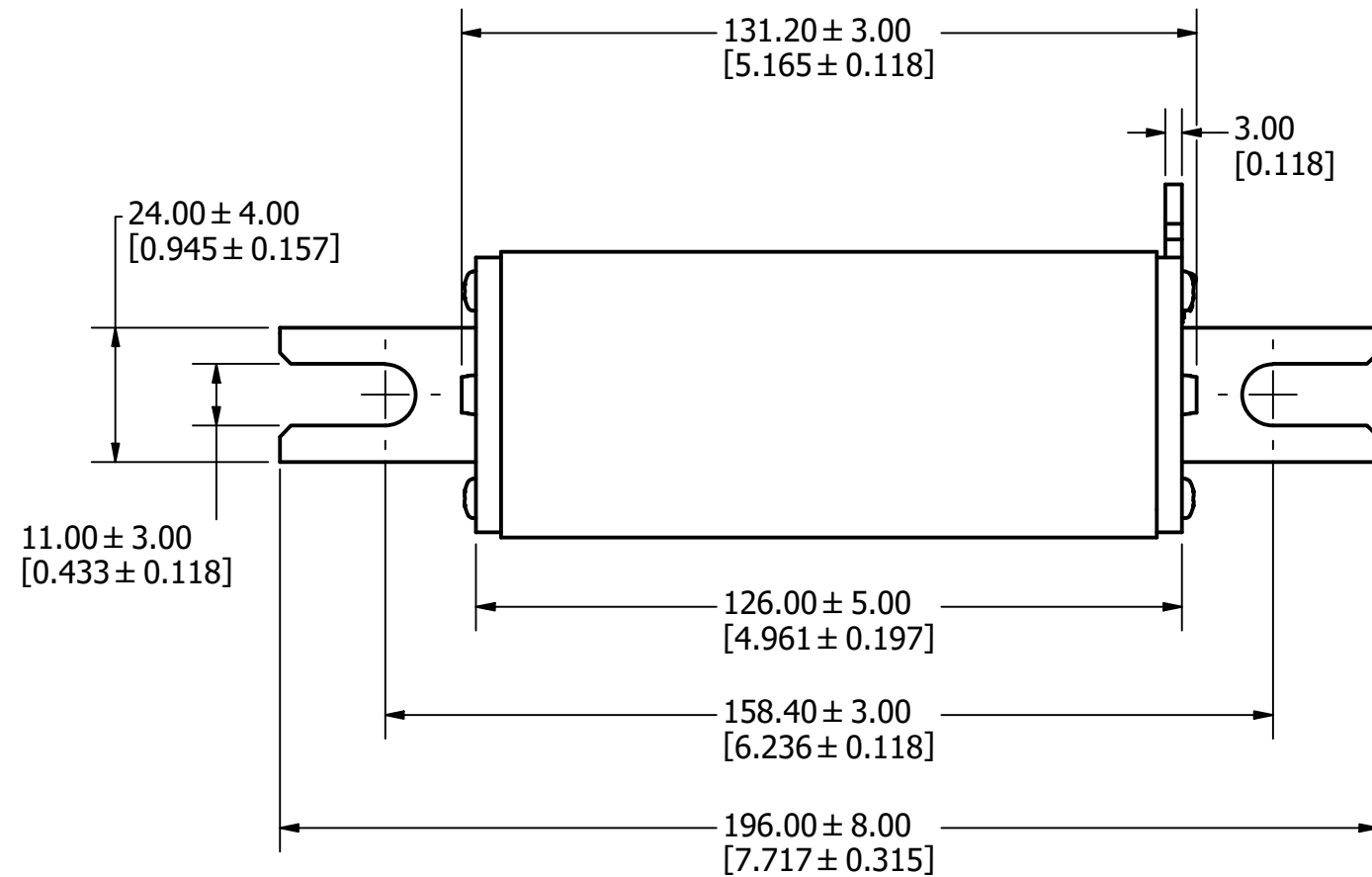

| | |
|-----|--|
| ● | DENOTES CRITICAL CHARACTERISTICS. |
| CPK | DENOTES CPK DIMENSIONS, -MINIMUM CPK VALUE |
| ⊠ | DENOTES A CHARACTERISTIC THAT PROVIDES AN INDICATION OF PROCESS PERFORMANCE. PROCEDURE FOR MEASUREMENT AND TRACKING TO BE DEFINED IN LITTELFUSE INSPECTION INSTRUCTIONS. |
| CP | DENOTES CP DIMENSIONS, -MINIMUM CP VALUE MUST BE WITHIN THE DIMENSIONAL LIMITATIONS SHOWN ON DRAWING AND INITIALLY LOCATED TO ALLOW FOR MAXIMUM TOOL LIFE. |

B

| | | | |
|-----------|----------------|-----------|----------------------------|
| MATL SPEC | | FINISH | |
| DRW MYORK | DATE 4/18/2018 | SCALE NTS | FINISH GOOD WT GRAMS/PIECE |

UNLESS OTHERWISE SPECIFIED, DIMENSIONS ARE IN MILLIMETERS, DIMENSIONS IN BRACKETS [] ARE INCHES DIMENSIONING AND DO NOT INCLUDE PLATING. TOLERANCING TO BE INTERPRETED IN ACCORDANCE WITH ANSI Y14.5M-1994

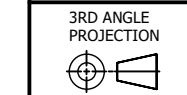

TITLE
1500VDC SIZE 1XL W/ U-BLADES PHOTOVOLTAIC FUSE W/ MICROSWITCH INTERFACE OUTLINE

| | | | |
|--|----------|-------------------|--------------|
| | REVISION | DRWG NO. | SHEET 1 OF 1 |
| | C | OL-SPNH000.XXDEMS | |