

THIS DRAWING AND THE INFORMATION CONTAINED WITHIN IT ARE CONFIDENTIAL AND MAY NOT BE COPIED OR DISCLOSED WITHOUT THE WRITTEN PERMISSION OF LITTELFUSE.

REVISIONS				
REV.	DESCRIPTION	DATE	DESIGNED	APPROVED
A	First issue of outline drawing	03-Aug-20	L.Dal Molin	M.Tinto

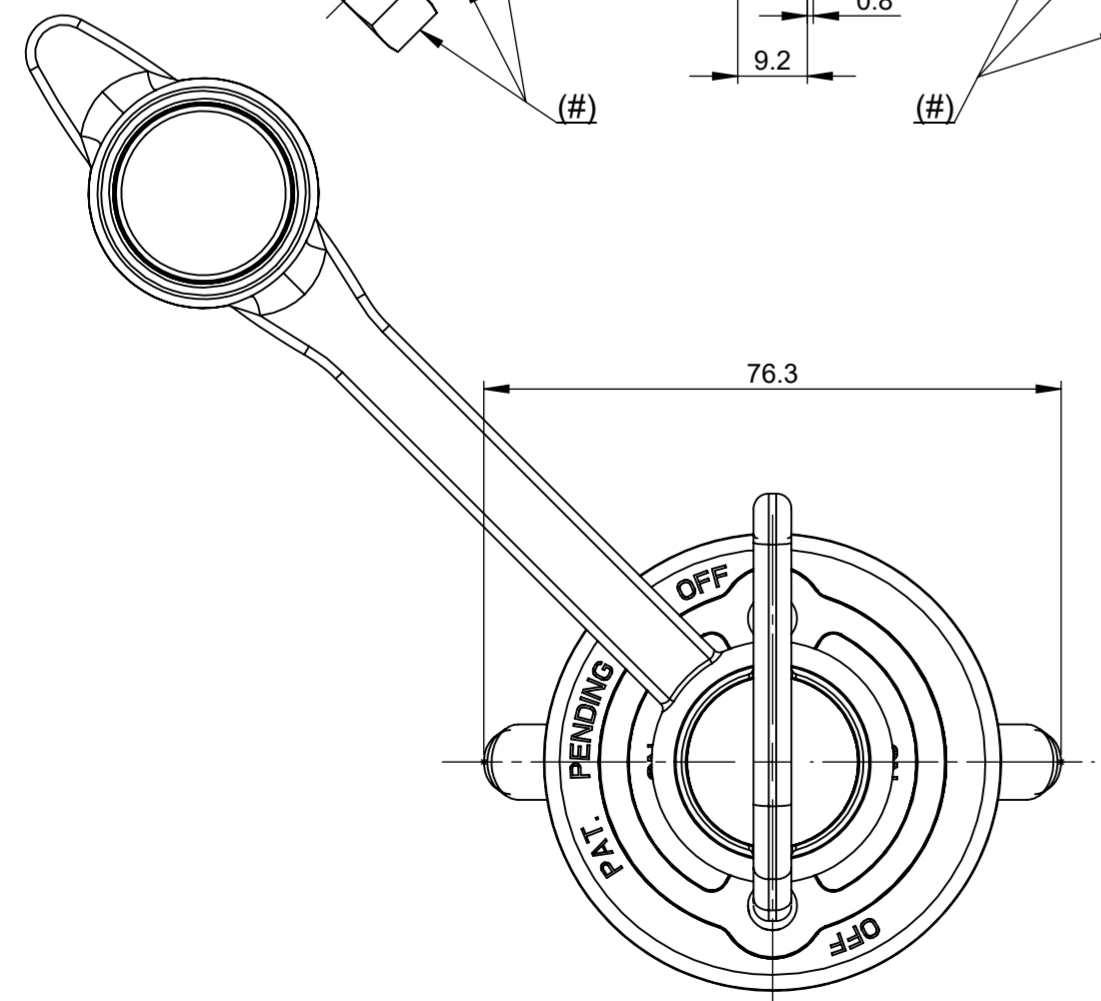

OPEN CONTACT ("OFF")
(View without flat washers - washer springs - nuts)

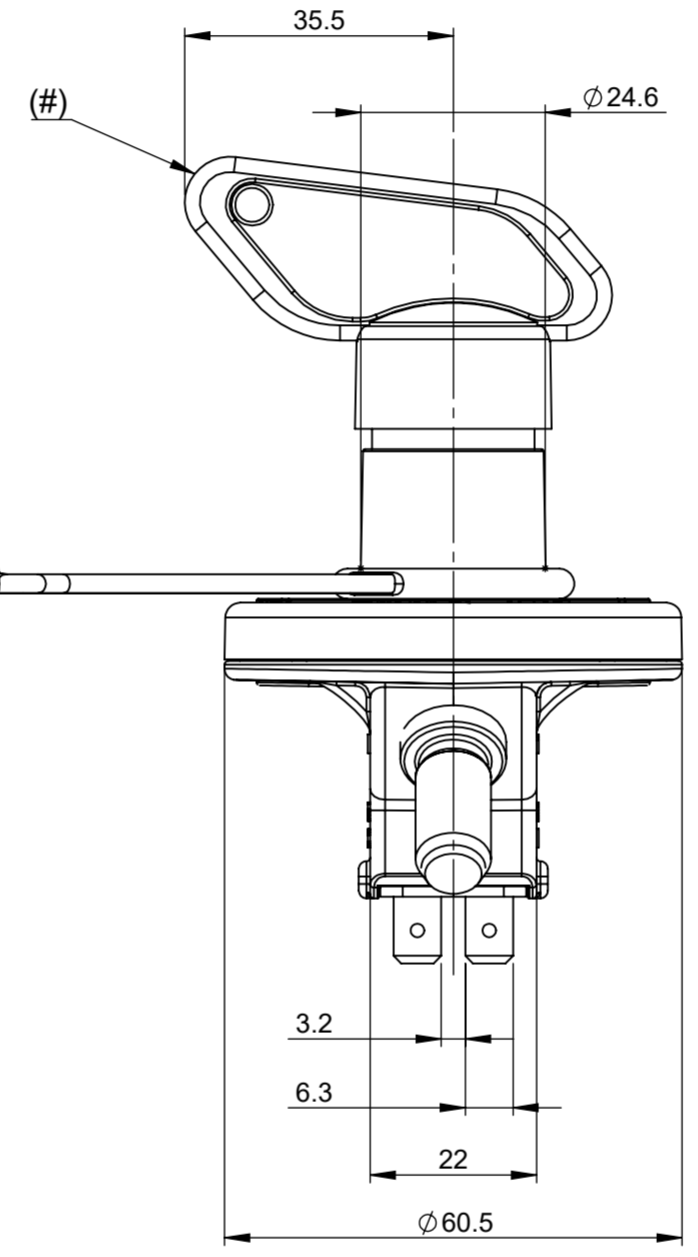
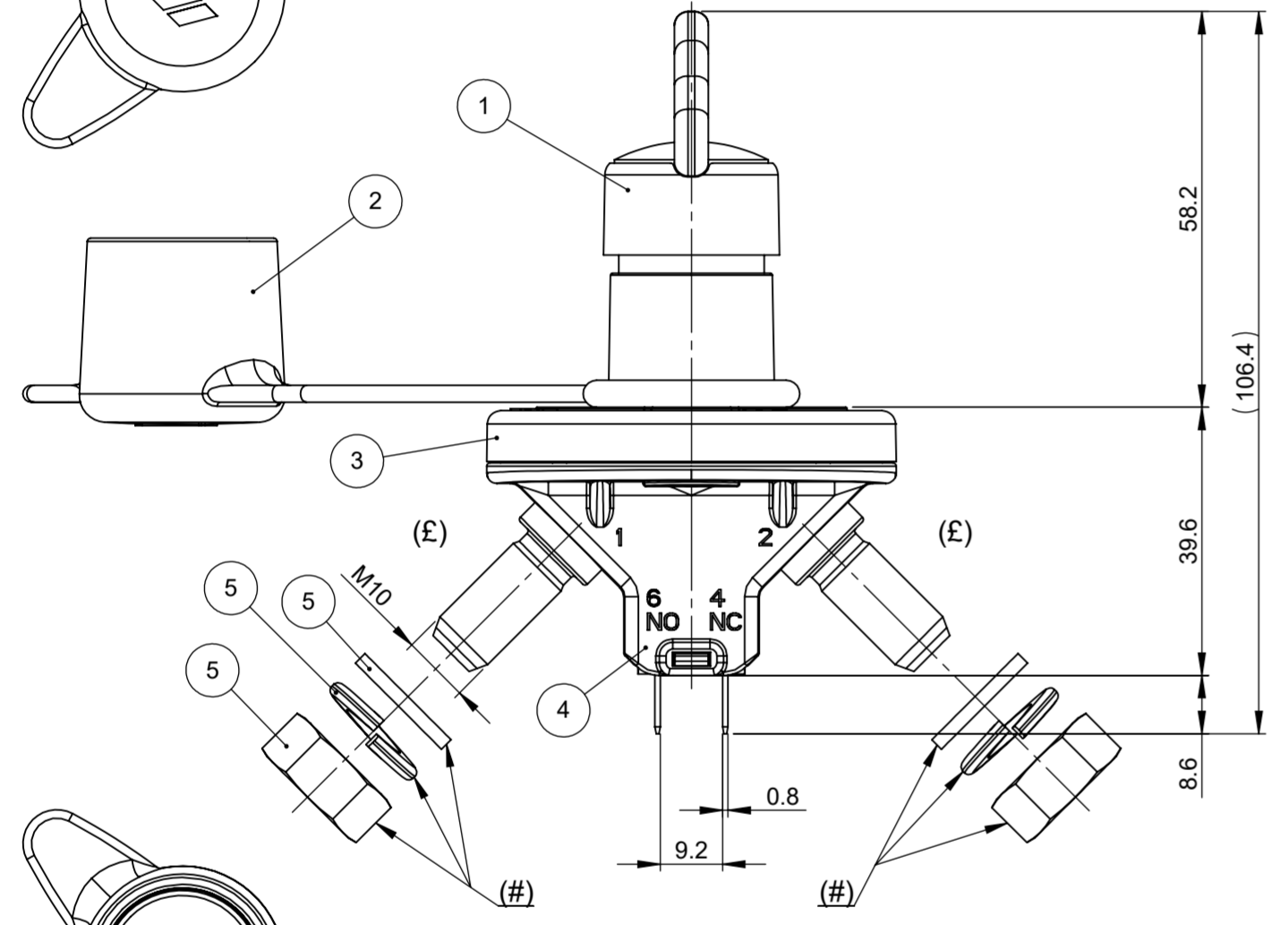
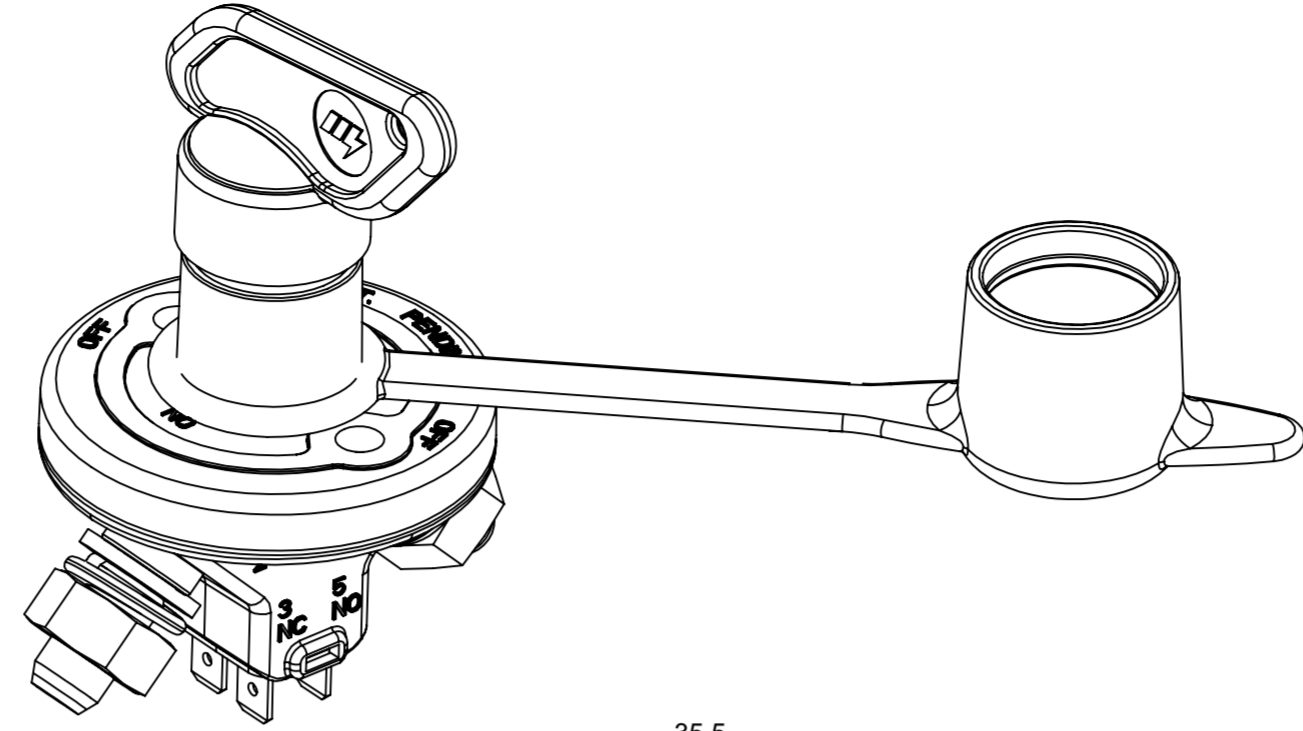
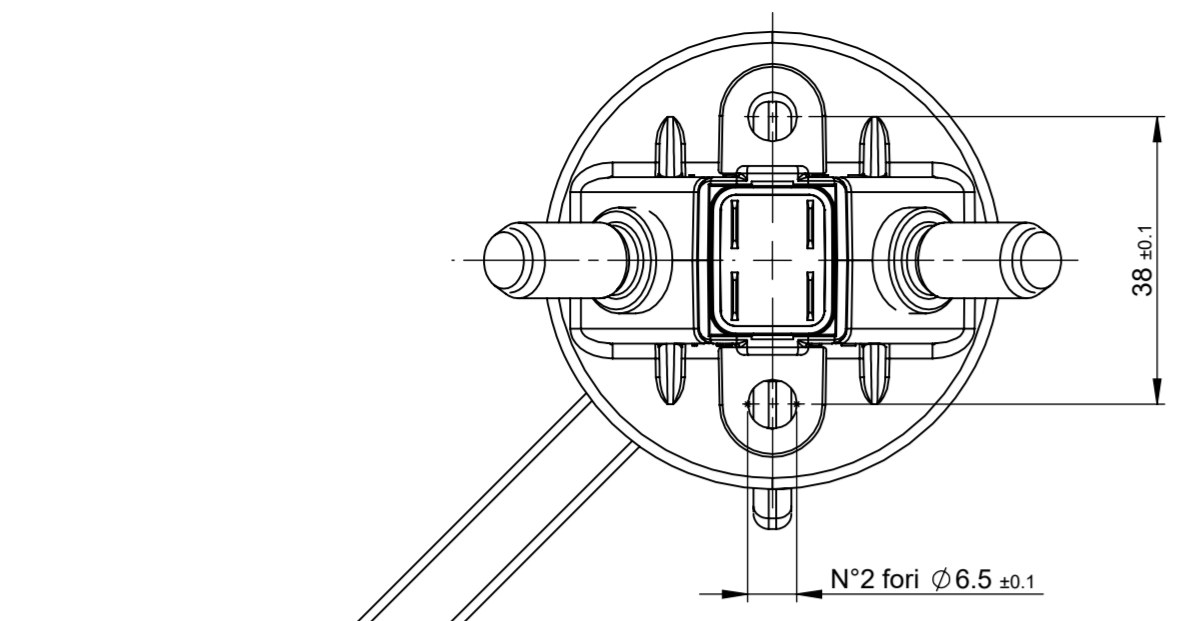
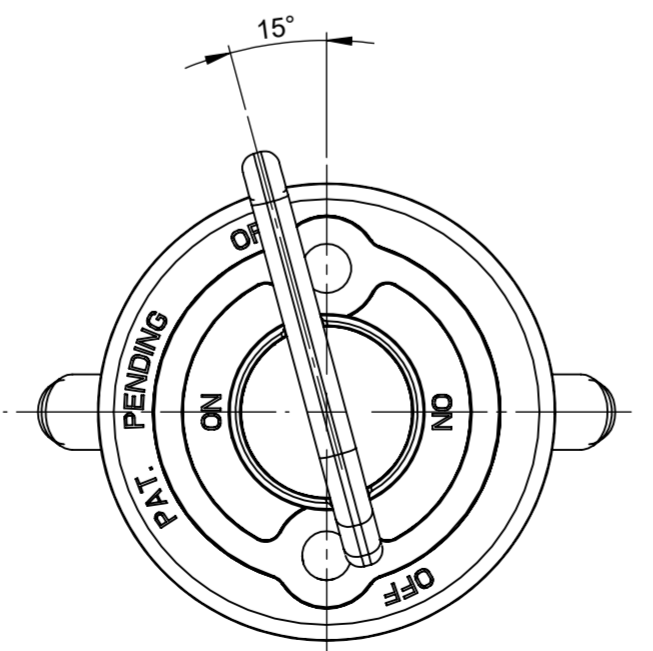

POSITION TO INSERT/REMOVE THE KEY
(View without flat washers - washer springs - nuts, and protection cap)

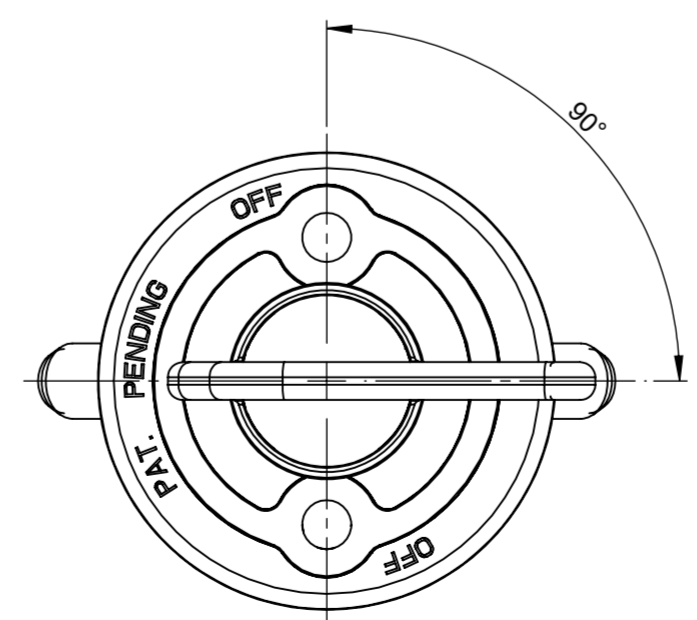

CLOSED CONTACT ("ON")
(View without flat washers - washer springs - nuts and protection cap)

CHARACTERISTICS

- Nominal voltage: 12-24V
- Maximum continuous current main contacts: 150A
- Maximum current main contacts short time: 1500A x 5s @23±5°C
- Maximum continuous current auxiliary contacts: 5A
- Maximum current auxiliary contacts short time: 120A x 5s @23±5°C
- M10 nuts tightening torque: 20±2 Nm

- (£) Marking of manufacturing date in accordance with Littelfuse Standard, indifferently on the side indicated in the drawing or on the opposite one
- Test the device in accordance with Littelfuse Specification

- (#) Components supplied not assembled: key, 2 M10 nuts, 2 flat washers and 2 washer springs

ASSEMBLY KEY

To assemble the key, insert it and turn it clockwise of 15° taking the device in state Switched OFF; to remove it, with the device in state Switched OFF turn it counterclockwise of 15° and extract it

OPERATION

- To close (switch on) the contacts: turn clockwise the key of 90°
- To open (switch off) the contacts: turn counterclockwise the key of 90°

POS.	P/N	DESCRIPTION	MATERIAL	Q.TY	U/M
5		Kit for Bms IGC/175		1	EA
4		Lower body complete		1	EA
3		Upper body with key	Polyamide	1	EA
2	00902700	Cap eyelet for key	Rubber	1	EA
1	00902200	Key complete	Polyamide	1	EA

DIMENSIONS AND TOLERANCES IN MILLIMETERS, DEFINED ACCORDING TO ISO 1101-2017.						
linear dimensions						
0,5	>3	>6	>30	>120	>400	>1000
3	6	30	120	400	1000	2000
±0,2	±0,3	±0,5	±0,8	±1,2	±2	±3
angle (for range of lengths)						
up to 10	>10	>50	>120	>400	>1200	>2000
±1°30'	±1°	±0°30'	±0°15'			
●	FIT/ FUNCTION CRITICAL CHARACTERISTICS SYMBOL					
<S>	SAFETY/ COMPLIANCE CRITICAL CHARACTERISTICS SYMBOL					
CPK	DENOTES CPK DIMENSIONS MINIMUM CPK VALUE					
ST	DENOTES A CHARACTERISTIC THAT PROVIDES AN INDICATION OF PROCESS PERFORMANCE. PROCEDURE FOR MEASUREMENT AND TRACKING TO BE DEFINED IN LITTELFUSE INSPECTION INSTRUCTIONS					
CP	DENOTES CP DIMENSIONS. MINIMUM CP VALUE MUST BE WITHIN THE DIMENSIONAL LIMITATIONS SHOWN ON DRAWING AND INITIALLY LOCATED TO ALLOW FOR MAXIMUM TOOL LIFE					
NAME		DATE		 Expertise Applied Answers Delivered		
DRAWN: L.Dal Molin		03-Aug-20				
CHECKED: -		-		TITLE		
-		-		IGC/175-CD		
-		-		SIZE: A2		
-		-		DWG. NO.: OL-08080400		
-		-		OUTLINE REV.: A		
DO NOT SCALE DRAWING		SCALE 1:1		SHEET 1 OF 1		

SAP drawing number:

Material and treatments: