

LSIC1MO170E0750
1700 V, 750 mOhm N-Channel SiC MOSFET

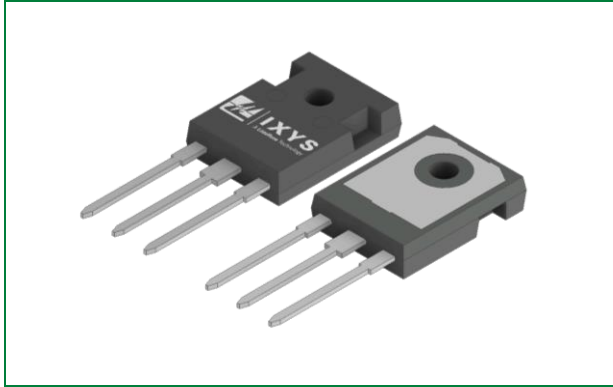

Agency Approvals and Environmental

Environmental Approvals



Circuit Diagram

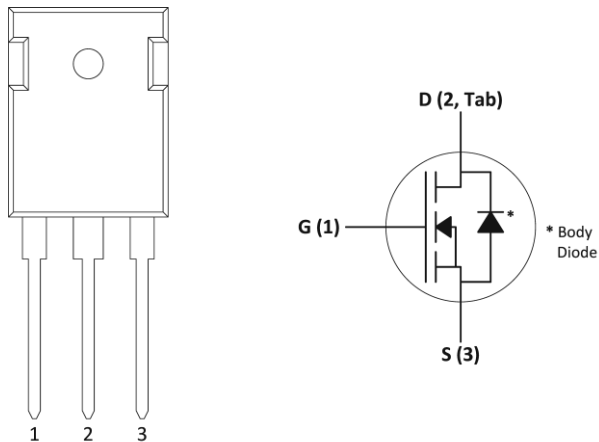

Product Summary

| Characteristic | Value | Unit |
|--|-------|------|
| V_{DS} | 1700 | V |
| Typical $R_{DS(ON)}$ | 750 | mOhm |
| I_D ($T_C \leq 100\text{ }^\circ\text{C}$) | 4.4 | A |

Features

- Optimized for high-frequency, high-efficiency applications
- Extremely low gate charge and output capacitance
- Low gate resistance for high-frequency switching
- Normally-off operations at all temperatures
- Ultra-low on-resistance

Applications

- High-frequency applications
- Solar Inverters
- Switch Mode Power Supplies
- UPS
- Motor Drives
- High Voltage DC/DC Converters
- Battery Chargers
- Induction Heating

1. Maximum Ratings.....3

2. Thermal Characteristics3

3. Electrical Characteristics3

 3.1. Static Characteristics ($T_J = 25\text{ }^\circ\text{C}$ unless otherwise specified)3

 3.2. Dynamic Characteristics ($T_J = 25\text{ }^\circ\text{C}$ unless otherwise specified)4

4. Reverse Diode Characteristics4

5. Figure Data5

6. Package Dimensions9

7. Part Numbering and Marking.....9

8. Packing Options9

9. Packing Specifications10

1. Maximum Ratings

| Characteristic | Symbol | Conditions | Value | Unit |
|-----------------------------------|-----------------------------|---|-------------|------------------|
| Drain-Source Voltage | V_{DS} | $V_{GS} = 0\text{ V}$ | 1700 | V |
| Continuous Drain Current | I_D | $V_{GS} = 20\text{ V}, T_C = 25\text{ }^\circ\text{C}$ | 6.2 | A |
| | | $V_{GS} = 20\text{ V}, T_C = 100\text{ }^\circ\text{C}$ | 4.4 | |
| Pulsed Drain Current ¹ | $I_{D(pulse)}$ | $T_C = 25\text{ }^\circ\text{C}$ | 11 | A |
| Power Dissipation | P_D | $T_C = 25\text{ }^\circ\text{C}, T_J = 175\text{ }^\circ\text{C}$ | 60 | W |
| Gate-Source Voltage | $V_{GS,MAX}$ | Absolute maximum values – Steady state | -6 to +22 | V |
| | $V_{GS,OP,TR}$ ² | Transient, $t_{transient} < 300\text{ nsec}$ | -10 to +25 | |
| | $V_{GS,OP}$ ³ | Recommended DC operating values | -5 to +20 | |
| Operating Junction Temperature | T_J | - | -55 to +175 | $^\circ\text{C}$ |
| Storage Temperature | T_{STG} | - | -55 to +150 | $^\circ\text{C}$ |
| Lead Temperature for Soldering | T_{SOLD} | - | 260 | $^\circ\text{C}$ |
| Mounting Torque | M_D | M3 or 6-32 screw | 1 | Nm |
| | | | 8.8 | in-lb |

Footnote 1: Pulse width limited by $T_{J,MAX}$

Footnote 2: See Figure 21 for further information

Footnote 3: MOSFET can operate with $V_{GS(OFF)} = 0\text{ V}$ – dependent upon PCB layout. $V_{GS(OFF)} = -5\text{ V}$ provides added noise margin and faster turn-off speed

2. Thermal Characteristics

| Characteristic | Symbol | Value | Unit |
|---|-----------------|-------|--------------------|
| Typical Thermal Resistance, junction-to-case | $R_{th,JC,MAX}$ | 2.5 | $^\circ\text{C/W}$ |
| Maximum Thermal Resistance, junction-to-ambient | $R_{th,JA,MAX}$ | 40 | $^\circ\text{C/W}$ |

3. Electrical Characteristics

3.1. Static Characteristics ($T_J = 25\text{ }^\circ\text{C}$ unless otherwise specified)

| Characteristic | Symbol | Conditions | Value | | | Unit |
|----------------------------------|---------------|--|-------|------|------|---------------|
| | | | Min | Typ | Max | |
| Drain-Source Breakdown Voltage | $V_{(BR)DSS}$ | $V_{GS} = 0\text{ V}, I_D = 100\text{ }\mu\text{A}$ | 1700 | - | - | V |
| Zero Gate Voltage Drain Current | I_{DSS} | $V_{DS} = 1700\text{ V}, V_{GS} = 0\text{ V}$ | - | 0.05 | 10 | μA |
| | | $V_{DS} = 1700\text{ V}, V_{GS} = 0\text{ V}, T_J = 175\text{ }^\circ\text{C}$ | - | 0.1 | - | |
| Gate Leakage Current | $I_{GSS,F}$ | $V_{GS} = 22\text{ V}, V_{DS} = 0\text{ V}$ | - | - | 100 | nA |
| | $I_{GSS,R}$ | $V_{GS} = -6\text{ V}, V_{DS} = 0\text{ V}$ | - | - | 100 | |
| Drain-Source On-State Resistance | $R_{DS(ON)}$ | $I_D = 2\text{ A}, V_{GS} = 20\text{ V}$ | - | 750 | 1000 | m Ω |
| | | $I_D = 2\text{ A}, V_{GS} = 20\text{ V}, T_J = 175\text{ }^\circ\text{C}$ | - | 1550 | - | |
| Gate Threshold Voltage | $V_{GS(TH)}$ | $V_{DS} = V_{GS}, I_D = 1\text{ mA}$ | 1.8 | 2.8 | 4.0 | V |
| | | $V_{DS} = V_{GS}, I_D = 1\text{ mA}, T_J = 175\text{ }^\circ\text{C}$ | - | 1.9 | - | |
| Gate Resistance | R_G | Resonance method, Drain-Source shorted ¹ | - | 29 | - | Ω |

Footnote 1: For a description of the resonance method for measuring R_G , refer to the JEDEC Standard JESD24-11 test method

3.2. Dynamic Characteristics (T_J = 25 °C unless otherwise specified)

| Characteristic | Symbol | Conditions | Value | | | Unit |
|----------------------------------|---------------------|---|-------|------|-----|------|
| | | | Min | Typ | Max | |
| Turn-On Switching Energy | E _{ON} | V _{DD} = 1200 V, I _D = 2 A, V _{GS} = -5 / +20 V, R _{G,ext} = 2 Ω, L = 1.4 mH, FWD = LSIC1MO170E0750 | - | 52 | - | μJ |
| Turn-Off Switching Energy | E _{OFF} | | - | 61 | - | |
| Total Per-Cycle Switching Energy | E _{TS} | | - | 113 | - | |
| Input Capacitance | C _{ISS} | V _{DD} = 1000 V, V _{GS} = 0 V, f = 1 MHz, V _{AC} = 25 mV | - | 200 | - | pF |
| Output Capacitance | C _{OSS} | | - | 11.5 | - | |
| Reverse Transfer Capacitance | C _{RSS} | | - | 1.7 | - | |
| COSS Stored Energy | E _{OSS} | | - | 5.7 | - | |
| Total Gate Charge | Q _g | V _{DD} = 1200 V, I _D = 2 A, V _{GS} = -5 / +20 V | - | 13 | - | nC |
| Gate-Source Charge | Q _{gs} | | - | 3.5 | - | |
| Gate-Drain Charge | Q _{gd} | | - | 6 | - | |
| Turn-On Delay Time | t _{d(on)} | V _{DD} = 1200 V, V _{GS} = -5 / +20 V, I _D = 2 A, R _{G,ext} = 2 Ω, R _L = 600 Ω, Timing relative to V _{DS} | - | 8 | - | ns |
| Rise Time | t _r | | - | 12 | - | |
| Turn-Off Delay Time | t _{d(off)} | | - | 23 | - | |
| Fall Time | t _f | | - | 74 | - | |

4. Reverse Diode Characteristics

| Characteristic | Symbol | Conditions | Value | | | Unit |
|---|-----------------|--|-------|-----|-----|------|
| | | | Min | Typ | Max | |
| Diode Forward Voltage | V _{SD} | I _S = 1 A, V _{GS} = 0 V | - | 3.7 | - | V |
| | | I _S = 1 A, V _{GS} = 0 V, T _J = 175 °C | - | 3.2 | - | |
| Continuous Diode Forward Current | I _S | V _{GS} = 0 V, T _C = 25 °C | - | - | 9 | A |
| Peak Diode Forward Current ¹ | I _{SP} | | - | - | 15 | |

Footnote 1: Pulse width limited by T_{J,MAX}

5. Figure Data

Figure 1. Maximum Power Dissipation ($T_J = 175\text{ }^\circ\text{C}$)

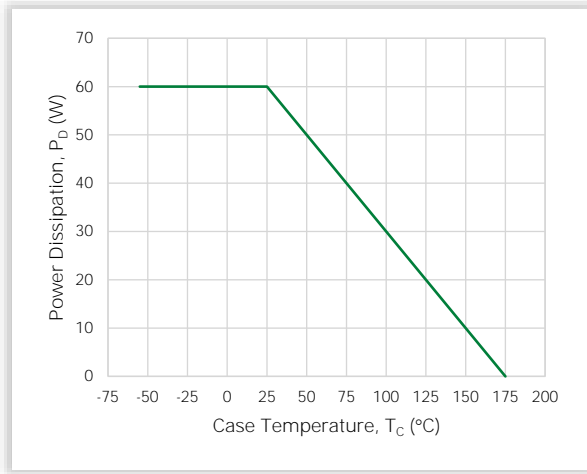

Figure 2. Typical Transfer Characteristics

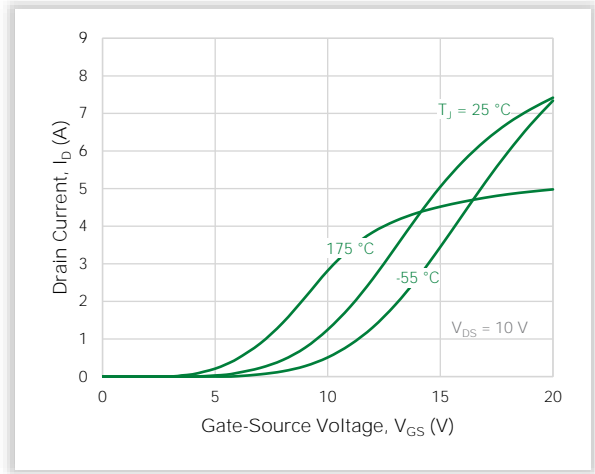

Figure 3. Typical Output Characteristics ($T_J = 25\text{ }^\circ\text{C}$)

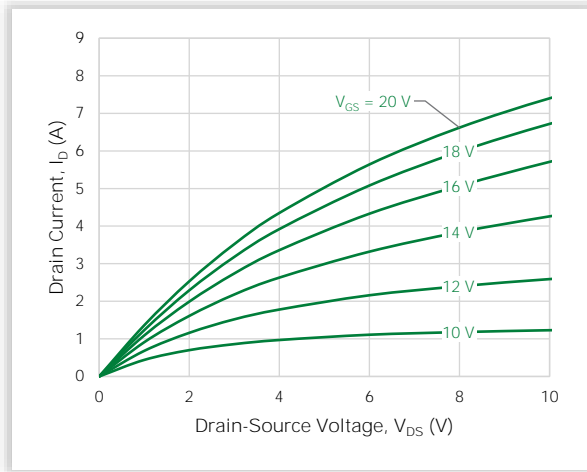

Figure 4. Typical Output Characteristics ($T_J = 175\text{ }^\circ\text{C}$)

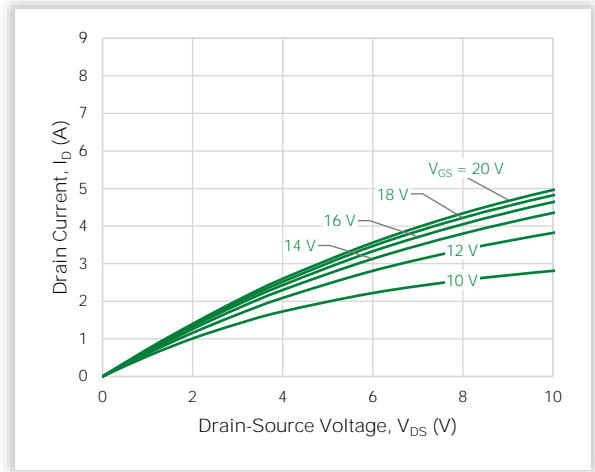

Figure 5. Typical Output Characteristics ($T_J = -55\text{ }^\circ\text{C}$)

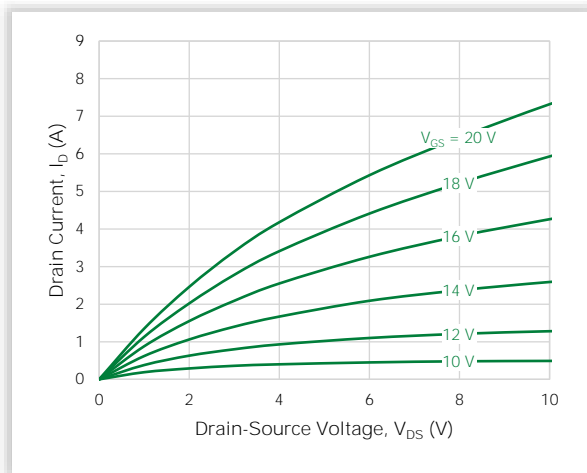

Figure 6. Typical Reverse Conduction Characteristics ($T_J = 25\text{ }^\circ\text{C}$)

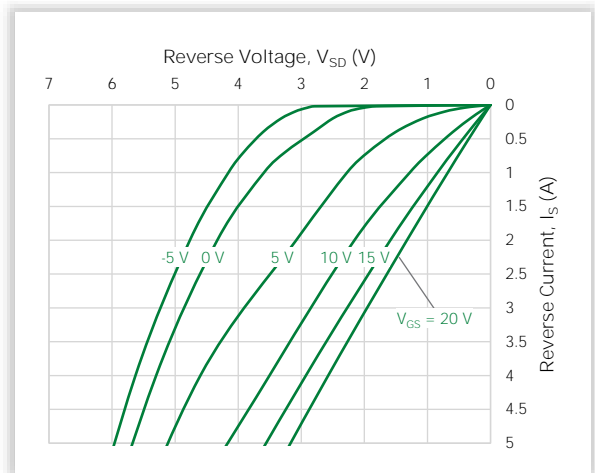

Figure 7. Typical Reverse Conduction Characteristics ($T_J = 175\text{ }^\circ\text{C}$)

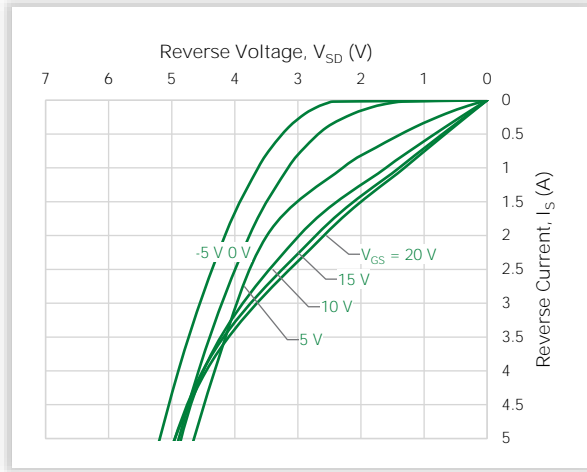

Figure 8. Typical Reverse Conduction Characteristics ($T_J = -55\text{ }^\circ\text{C}$)

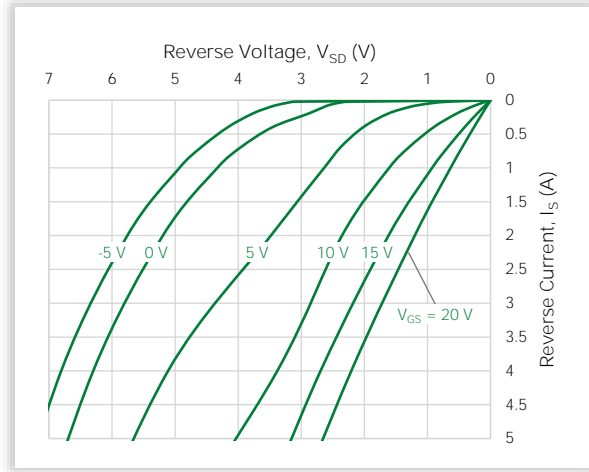

Figure 9. Transient Thermal Impedance

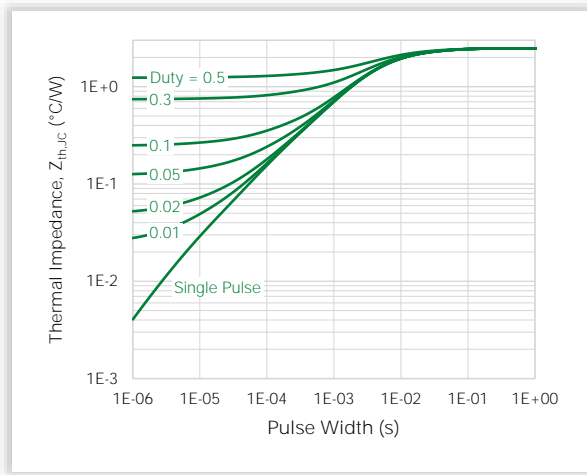

Figure 10. Maximum Safe Operating Area ($T_C = 25\text{ }^\circ\text{C}$)

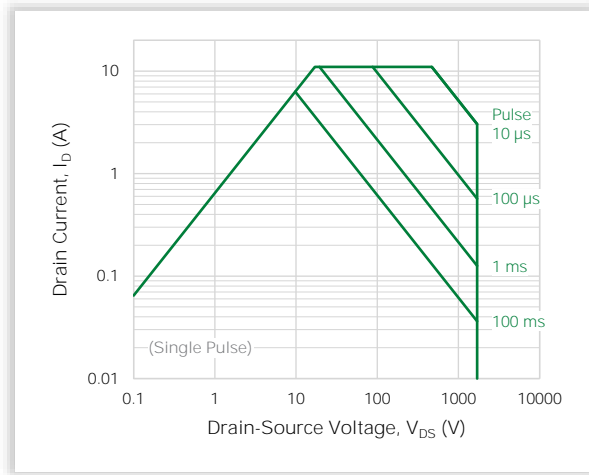

Figure 11. Typical On-resistance vs. Drain Current

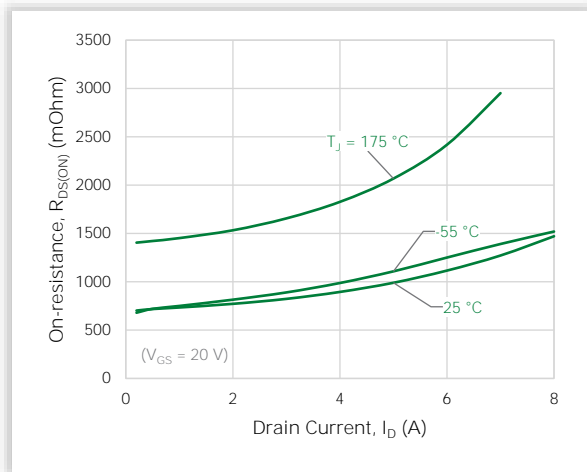

Figure 12. Normalized On-resistance vs. Junction Temperature

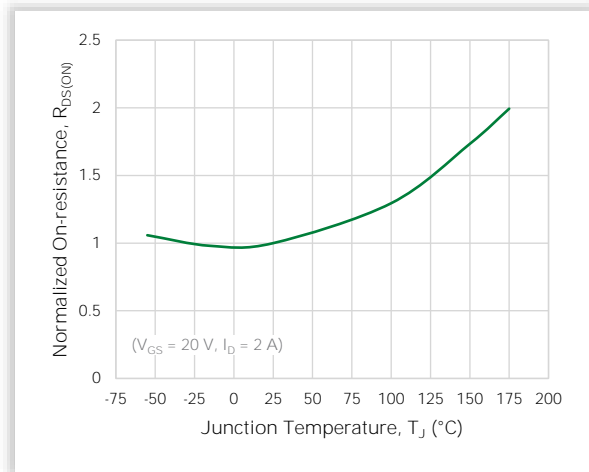

Figure 13. Typical On-resistance vs. Junction Temperature

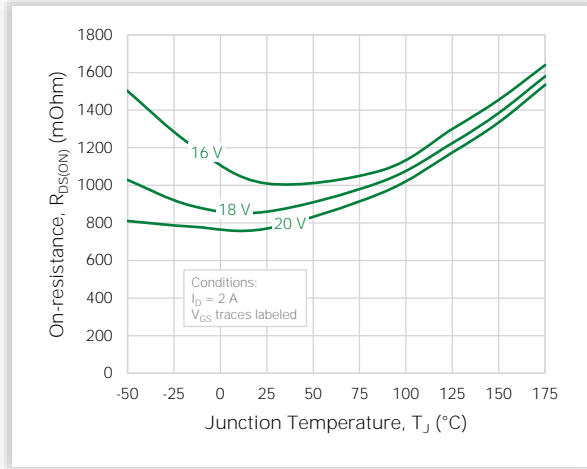

Figure 14. Typical Threshold Voltage

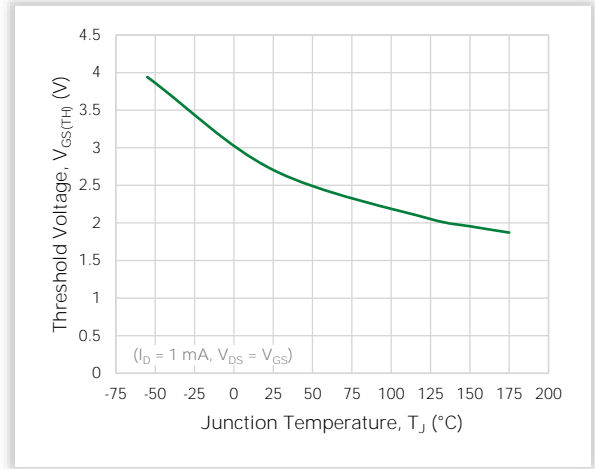

Figure 15. Typical Junction Capacitances up to 1000 V

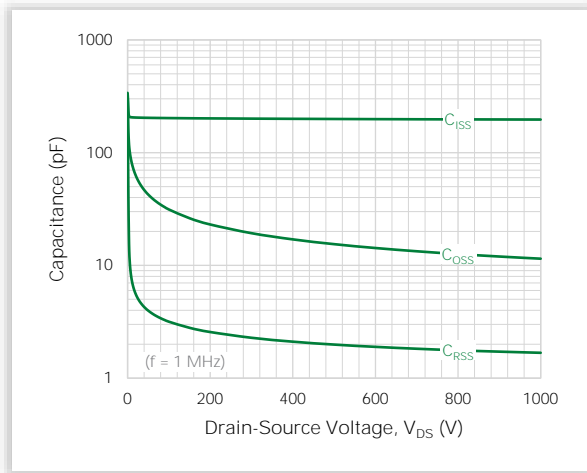

Figure 16. Typical Junction Capacitances up to 200 V

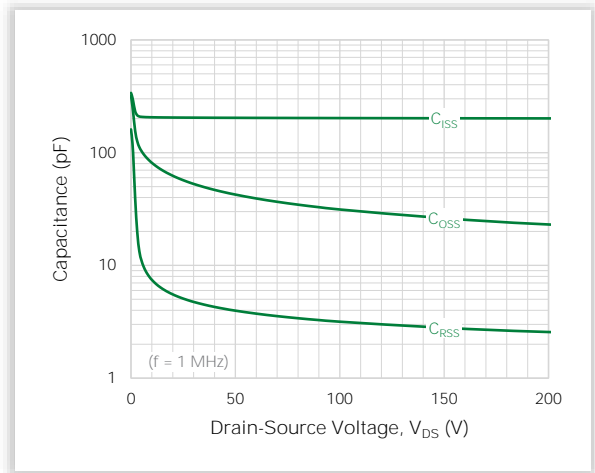

Figure 17. Typical C_{oss} Stored Energy E_{oss}

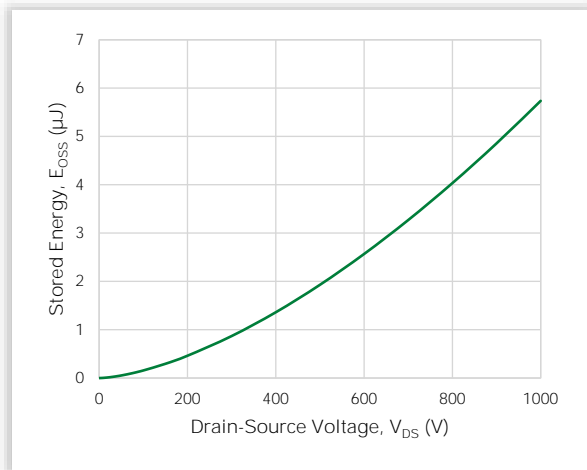

Figure 18. Typical Gate Charge

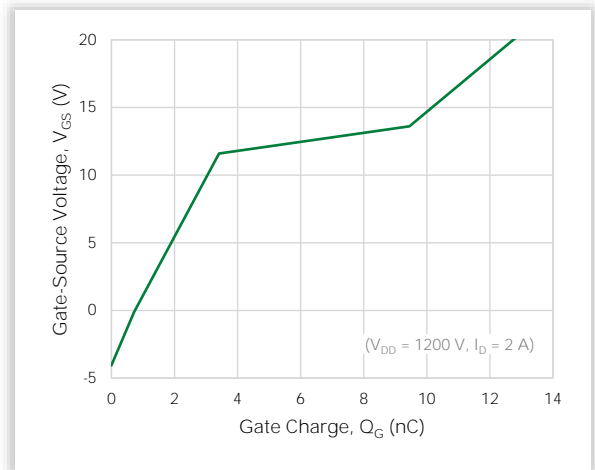

Figure 19. Typical Switching Energy vs. Drain Current

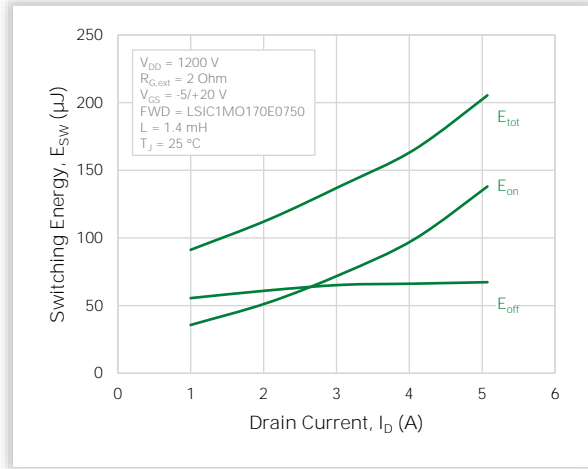

Figure 20. Typical Switching Energy vs. External Gate Resistance

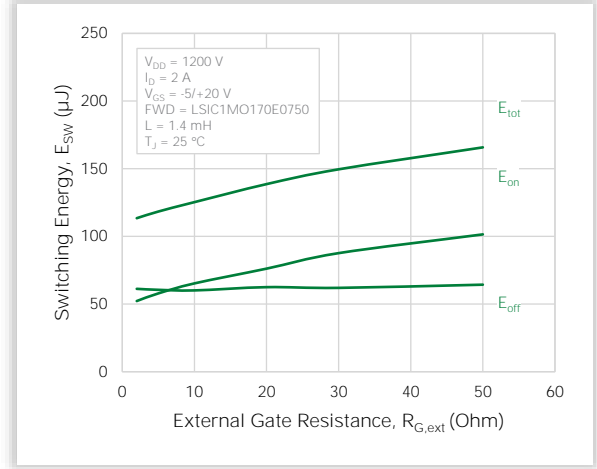
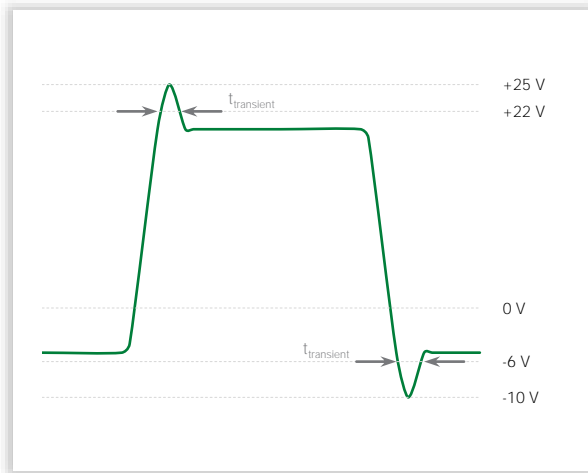
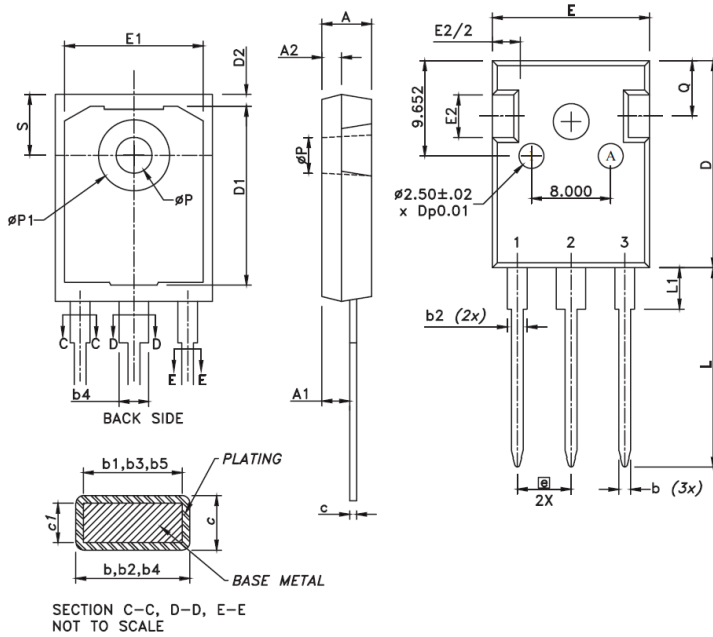

Figure 21. V_{GS} Waveform Definitions



6. Package Dimensions



| Symbol | Millimeters | | |
|--------|-------------|-----|--------|
| | Min | Nom | Max |
| A | 4.699 | - | 5.309 |
| A1 | 2.210 | - | 2.591 |
| A2 | 1.499 | - | 2.489 |
| b | 0.990 | - | 1.400 |
| b2 | 1.650 | - | 2.390 |
| b4 | 2.590 | - | 3.430 |
| c | 0.380 | - | 0.890 |
| D | 20.800 | - | 21.463 |
| D1 | 13.081 | - | - |
| D2 | 0.508 | - | 1.350 |
| e | 5.440 BSC | | |
| E | 15.494 | - | 16.256 |
| E1 | 13.060 | - | 14.150 |
| E2 | 3.429 | - | 5.486 |
| L | 19.810 | - | 20.570 |
| L1 | 3.810 | - | 4.496 |
| øP | 3.550 | - | 3.660 |
| øP1 | 7.060 | - | 7.390 |
| Q | 5.385 | - | 6.200 |
| S | 6.050 | - | 6.300 |

Recommended Hole Pattern Layout:

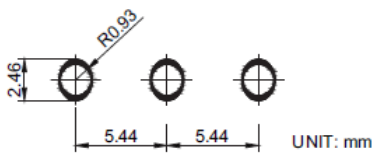

Notes:

1. Dimensions are in millimeters
2. Dimensions D & E do not include mold flash. Mold flash shall not exceed 0.127 mm per side. These dimensions are measured at the outermost extreme of the plastic body.
3. øP to have a maximum draft angle of 1.7° to the top of the part with a maximum hole diameter of 3.912 mm.

7. Part Numbering and Marking

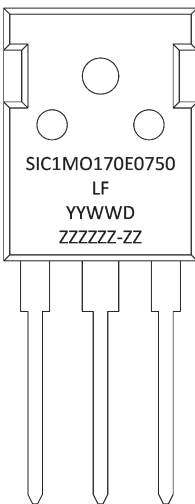

- SiC = SiC
- 1 = Gen 1
- MO = MOSFET
- 170 = Voltage Rating (1700 V)
- E = TO-247-3L
- 0750 = $R_{DS(ON)}$ (750 mOhm)
- YY = Year
- WW = Week
- D = Special Code
- ZZZZZZ-ZZ = Lot Number

8. Packing Options

| Part Number | Marking | Packing Mode | M.O.Q. |
|-----------------|----------------|---------------|--------|
| LSIC1MO170E0750 | SIC1MO170E0750 | Tube (30 Pcs) | 450 |

9. Packing Specifications

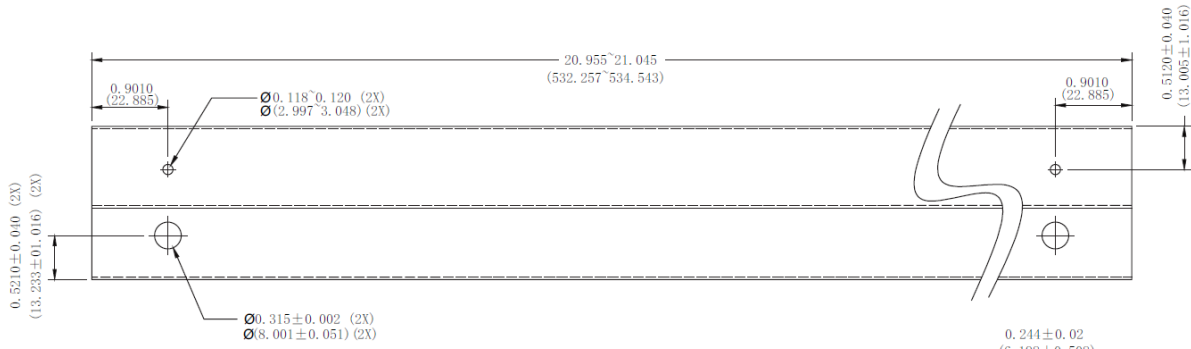

NOTE:

- 1. All pin plug holes are considered critical dimension
- 2. Tolerance is to be ±0.010 unless otherwise specified
- 3. Dimension are in inch (and millimeters).

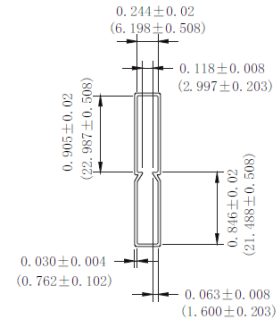

For additional information please visit www.Littelfuse.com/powersemi

Disclaimer Notice - Littelfuse products are not designed for, and shall not be used for, any purpose (including, without limitation, automotive, military, aerospace, medical, life-saving, life-sustaining or nuclear facility applications, devices intended for surgical implant into the body, or any other application in which the failure or lack of desired operation of the product may result in personal injury, death, or property damage) other than those expressly forth in applicable Littelfuse product documentation. Littelfuse shall not be liable for any claims or damages arising out of products used in applications not expressly intended by Littelfuse as set forth in applicable Littelfuse documentation.

Read complete Disclaimer Notice at www.littelfuse.com/disclaimer-electronics