

REVISION		DESCRIPTION
REV	DATE	Value
A	12/22/2006	

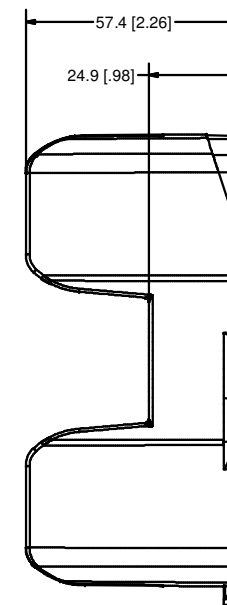
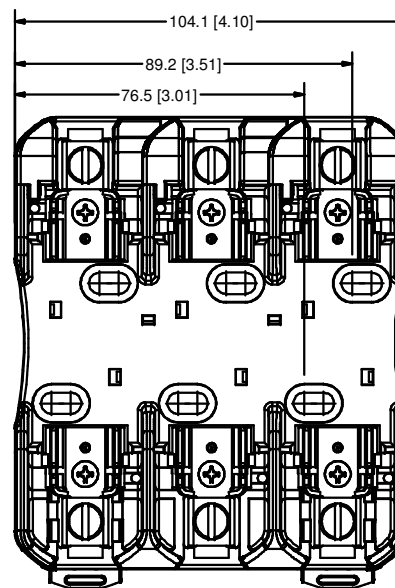
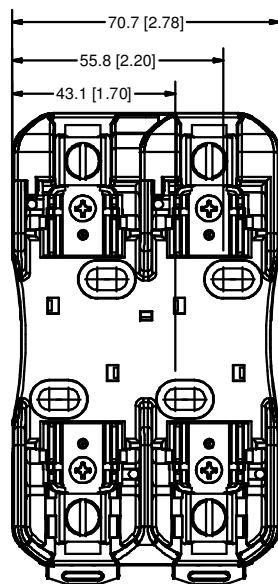
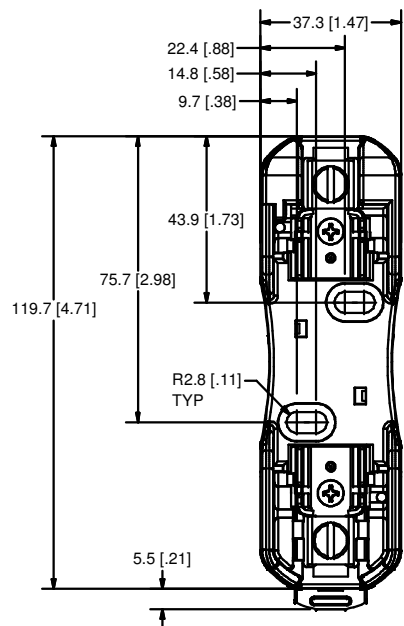

SPECIFICATIONS:

VOLTAGE RATING: 250V

AMPERE RATING: 60 AMPERES

INTERRUPT RATING: 10kA

TERMINAL TYPE: BOX LUG

SUGGESTED TORQUE: 5.6 N-m (50 IN-LBS) 2-4 AWG
2.8 N-m (25 IN-LBS) 6-14 AWG

WIRE RANGE: 2-14 AWG Cu/Al
SOLID/STRANDED

APPROVALS: UL LISTED (FILE NO. E14721)
CSA CERTIFIED (FILE NO. LR73091)

●	DENOTES CRITICAL CHARACTERISTICS.
CPK	DENOTES CPK DIMENSIONS, -MINIMUM CPK VALUE
(ST)	DENOTES A CHARACTERISTIC THAT PROVIDES AN INDICATION OF PROCESS PERFORMANCE. PROCEDURE FOR MEASUREMENT AND TRACKING TO BE DEFINED IN LITTELFUSE INSPECTION INSTRUCTIONS.
CP	DENOTES CP DIMENSIONS, -MINIMUM CP VALUE MUST BE WITHIN THE DIMENSIONAL LIMITATIONS SHOWN ON DRAWING AND INITIALLY LOCATED TO ALLOW FOR MAXIMUM TOOL LIFE.

MATL SPEC	FINISH		
DRW M. York	DATE 2/9/2010	SCALE NTS	FINISH GOOD WT GRAMS/PIECE

UNLESS OTHERWISE SPECIFIED, DIMENSIONS ARE IN MILLIMETERS, DIMENSIONS IN BRACKETS [] ARE INCHES DIMENSIONING AND DO NOT INCLUDE PLATING. TOLERANCING TO BE INTERPRETED IN ACCORDANCE WITH ANSI Y14.5M-1994

3RD ANGLE PROJECTION	
----------------------	--

TITLE LFH25060 OUTLINE

Littelfuse DES PLAINES, ILLINOIS 60016	REVISION A	DRWG NO. OL-LFH25060 Series	SHEET 1 OF 1
--	---------------	--------------------------------	--------------