

# 30EV Series

## High Voltage Fuses – Rated 500 V DC

RoHS

### Description

Bolt-down 30EV fuses designed for circuit protection in high-voltage, high-current automotive systems. These fuses make particularly good choices for ensuring overcurrent protection to branch circuits in EVs and hybrid passenger vehicles.

### Features & Benefits

- High-contrast ampere marking on bodies aid identification
- M8 and M6 versions available
- Industry-standard footprints
- Refers to ISO 8820-8

### Applications

- EVs
- Hybrid passenger vehicles

[See Disclaimer Notice](#)

### Additional Information



Resources



Samples

### Specifications

|                                               |                                                |
|-----------------------------------------------|------------------------------------------------|
| <b>Voltage Rating:</b>                        | 500 V DC                                       |
| <b>Interrupting Rating:</b>                   | 30 kA @ 500 V DC                               |
| <b>Recommended Environmental Temperature:</b> | -40 °C to +125 °C                              |
| <b>Terminals Material:</b>                    | Copper / Copper Alloy                          |
| <b>Housing Material:</b>                      | Melamine<br>(U.L. 94 Flammability rating – V0) |
| <b>End caps Material:</b>                     | Zinc Alloy                                     |
| <b>Recommended Mounting Torque M8:</b>        | 12 ±1 Nm                                       |
| <b>Recommended Mounting Torque M6:</b>        | 6 ±1 Nm (Max. allowed 10 Nm)                   |
| <b>Net Weight per Fuse:</b>                   | 100 g ±10% g                                   |
| <b>Refers To:</b>                             | ISO 8820-8                                     |

### Ordering Information

| Part Number      | Current Rating (A) | Termination  | Package Size |
|------------------|--------------------|--------------|--------------|
| 30EVxxx.ZXBDM    | 150 A - 300 A      | M8 Bolt Down | 72           |
| 30EVxxx.ZXBDM-M6 | 150 A - 300 A      | M6 Bolt Down | 72           |

# 30EV Series

## High Voltage Fuses – Rated 500 V DC

### Ratings

| Part Number   | Current Rating (A) | Test Cable Size (mm <sup>2</sup> ) | Typ. Voltage Drop (mV) | Max. Voltage Drop Spec at 100% IR (mV) | Typ. Cold Resistance (mΩ) | Typical Melting I <sup>2</sup> t (A <sup>2</sup> s) |
|---------------|--------------------|------------------------------------|------------------------|----------------------------------------|---------------------------|-----------------------------------------------------|
| 30EV150.ZXBDM | 150                | 20                                 | 160                    | 180                                    | 0.54                      | 15 000                                              |
| 30EV175.ZXBDM | 175                | 20                                 | 160                    | 180                                    | 0.46                      | 22 000                                              |
| 30EV200.ZXBDM | 200                | 30                                 | 160                    | 180                                    | 0.41                      | 32 000                                              |
| 30EV225.ZXBDM | 225                | 40                                 | 160                    | 180                                    | 0.36                      | 41 000                                              |
| 30EV250.ZXBDM | 250                | 40                                 | 160                    | 180                                    | 0.32                      | 52 000                                              |
| 30EV300.ZXBDM | 300                | 50                                 | 160                    | 180                                    | 0.27                      | 101 000                                             |

The typical I<sup>2</sup>t is an average value calculated from the breaking capacity tests by using the melting time before the arcing occurs.

### Dimensions

Dimensions in mm. Please refer to the outline drawing for dimensions and tolerances.

M8 Version

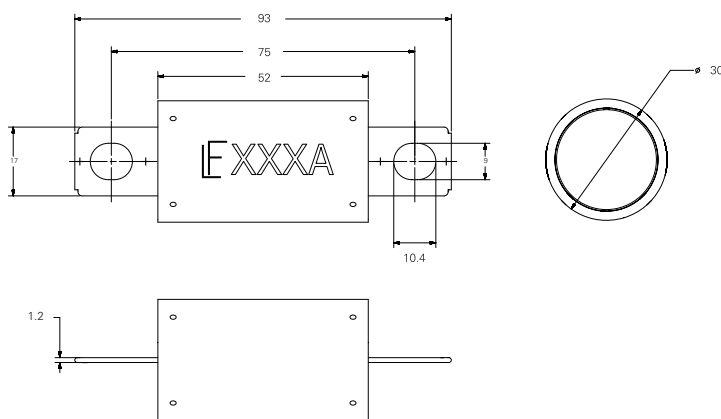

M6 Version

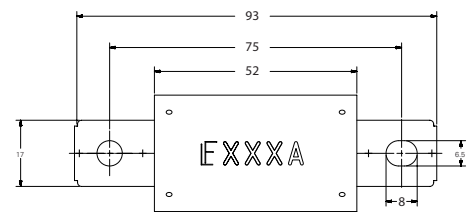

# 30EV Series

## High Voltage Fuses – Rated 500 V DC

### Time-Current Characteristic

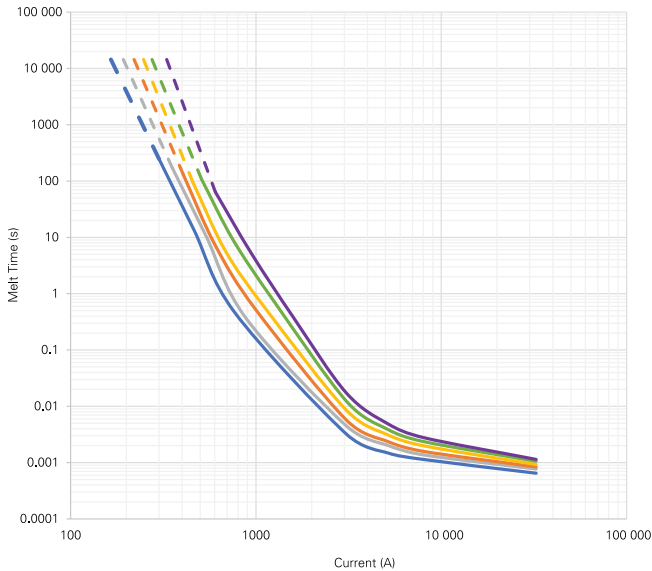

| % of Rating | Opening Time Min. / Max. (s) |
|-------------|------------------------------|
| 110         | 14 400 / -                   |
| 200         | 1 / 300                      |
| 300         | 0.2 / 30                     |
| 500         | 0.05 / 1                     |

- 150 A
- 175 A
- 200 A
- 225 A
- 250 A
- 300 A

**Note:** Current recommendation may be impacted by the final condition of the application (terminals characteristics, wire size etc.). Please contact Littelfuse® for more information.

### Typical Derating Curves

Temperature security margin is 20%.

Please contact Littelfuse® for Details Regarding Derating Test Set Up.

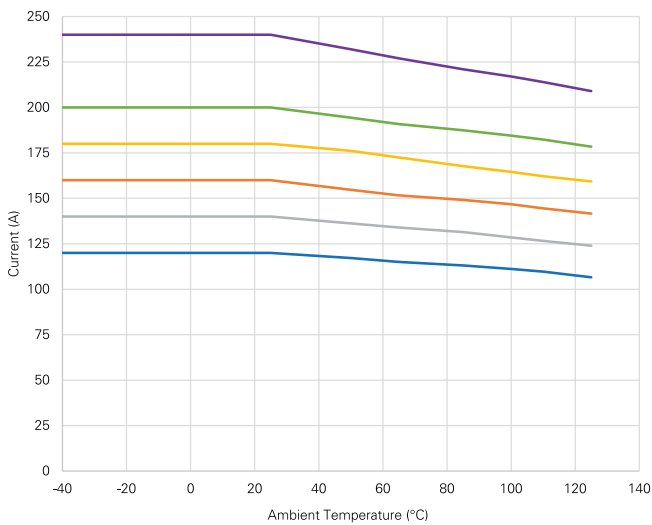

|              | Max. allowed current load (A) at ambient temperature based on typical derating |      |       |       |       |        |        |
|--------------|--------------------------------------------------------------------------------|------|-------|-------|-------|--------|--------|
|              | -40 °C                                                                         | 0 °C | 25 °C | 65 °C | 85 °C | 110 °C | 125 °C |
| <b>150 A</b> | 120                                                                            | 120  | 120   | 115   | 113   | 110    | 107    |
| <b>175 A</b> | 140                                                                            | 140  | 140   | 134   | 132   | 127    | 124    |
| <b>200 A</b> | 160                                                                            | 160  | 160   | 152   | 149   | 145    | 142    |
| <b>225 A</b> | 180                                                                            | 180  | 180   | 173   | 168   | 162    | 159    |
| <b>250 A</b> | 200                                                                            | 200  | 200   | 191   | 188   | 182    | 178    |
| <b>300 A</b> | 240                                                                            | 240  | 240   | 227   | 221   | 214    | 209    |

- 150 A
- 175 A
- 200 A
- 225 A
- 250 A
- 300 A

**Note:** Current recommendation may be impacted by the final condition of the application (terminals characteristics, wire size etc.). Please contact Littelfuse® for more information.

**Disclaimer Notice** - Information furnished is believed to be accurate and reliable. However, users should independently evaluate the suitability of and test each product selected for their own applications. Littelfuse products are not designed for, and may not be used in, all applications. Read complete Disclaimer Notice at <https://www.littelfuse.com/legal/disclaimers/product-disclaimer.aspx>