

REVISION		
REV	DATE	DESCRIPTION
A	8/9/22	525545GCP - RELEASE MRY

$\varnothing 14.3 \pm .15$   
 $[\varnothing .562 \pm .006]$

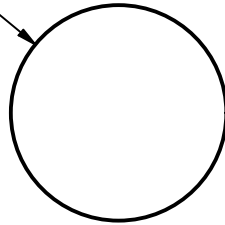

APPROXIMATE SHIPPING WEIGHT: 10 FUSES / 0.3 LBS.

7.1  
 $[\ .281 ]$

$38.1 \pm 1.02$   
 $[1.500 \pm .040]$

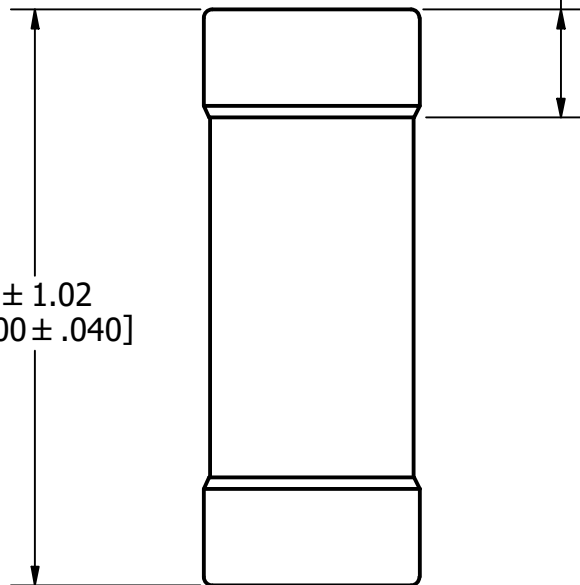

1	NO	COMPONENT NO	DESCRIPTION	QTY/M	U/M
<b>BILL OF MATERIAL</b>					
<S>	CRITICAL CHARACTERISTIC FOR PART SAFETY/COMPLIANCE				
●	DENOTES CRITICAL CHARACTERISTICS.				
CPK	DENOTES CPK DIMENSIONS, -MINIMUM CPK VALUE				
⊠	DENOTES A CHARACTERISTIC THAT PROVIDES AN INDICATION OF PROCESS PERFORMANCE. PROCEDURE FOR MEASUREMENT AND TRACKING TO BE DEFINED IN LITTELFUSE INSPECTION INSTRUCTIONS.				
CP	DENOTES CP DIMENSIONS, -MINIMUM CP VALUE MUST BE WITHIN THE DIMENSIONAL LIMITATIONS SHOWN ON DRAWING AND INITIALLY LOCATED TO ALLOW FOR MAXIMUM TOOL LIFE.				<b>A</b>
MATL SPEC			FINISH		
DRW JMoler	DATE 8/3/2022	SCALE NTS	FINISH GOOD WT GRAMS/PIECE		
UNLESS OTHERWISE SPECIFIED, DIMENSIONS ARE IN MILLIMETERS, DIMENSIONS IN BRACKETS [ ] ARE INCHES DIMENSIONING AND DO NOT INCLUDE PLATING. TOLERANCING TO BE INTERPRETED IN ACCORDANCE WITH ANSI Y14.5M-1994					
3RD ANGLE PROJECTION					
<b>TITLE</b> JLLS 1-30A OUTLINE					
<b>Littelfuse</b> <small>CHICAGO, ILLINOIS 60631</small>			REVISION <b>A</b>	DRWG NO. <b>OL-JLLS030</b>	SHEET 1 OF 1