

THIS DRAWING AND THE INFORMATION CONTAINED WITHIN IT ARE CONFIDENTIAL AND MAY NOT BE COPIED OR DISCLOSED WITHOUT THE WRITTEN PERMISSION OF LITTELFUSE.

REVISIONS				
ZONE	REV.	DESCRIPTION	DATE	APPROVED
	A	EC #514501 INITIAL RELEASE	2015/06/25	

67212 HARDWARE KIT CONTAINS:

1. 82401 FACE NUT QT'Y:1
2. 83452-601 2 BOOTED KEYS RINGED QT'Y:1

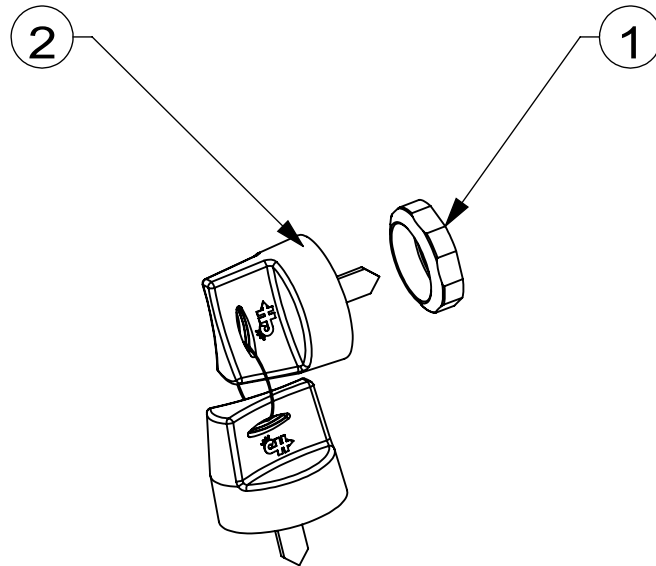

NOTES:

1. KIT MATCHES WITH SWITCH 95067
2. SINGLE KEY CODE 601
3. KEY BOOT FITS OVER FACE NUT AFTER ASSEMBLY

DIMENSIONS ARE SHOWN IN MILLIMETERS. DIMENSIONS AND TOLERANCES ARE DEFINED ACCORDING TO ANSI/ASME Y14.5-1994.						
●	DENOTES PRODUCTS CRITICAL CHARACTERISTICS					
CPK	DENOTES CPK DIMENSIONS MINIMUM CPK VALUE					
ST	DENOTES A CHARACTERISTIC THAT PROVIDES AN INDICATION OF PROCESS PERFORMANCE PROCEDURE FOR MEASUREMENT AND TRACKING TO BE DEFINED IN LITTELFUSE INSPECTION INSTRUCTIONS					
CP	DENOTES CP DIMENSIONS, -MINIMUM CP VALUE MUST BE WITHIN THE DIMENSIONAL LIMITATIONS SHOWN ON DRAWING AND INITIALLY LOCATED TO ALLOW FOR MAXIMUM TOOL LIFE					
TOLERANCES UNLESS OTHERWISE SPECIFIED (REF.ISO2768-M)						
DIMENSION	UP TO 0.5 - 3	OVER 3 - 6	UP TO 6 - 30	OVER 30 - 120	UP TO 120 - 400	ANGLE
TOLERANCES	±0.1	±0.1	±0.2	±0.3	±0.5	±0.5°
	NAME	DATE	 Expertise Applied Answers Delivered No.6 Xinghai Street, Suzhou Industry Park, China Phone +86 512 6761 3189 Fax +86 512 6761 1489			
DRAWN	JASON LI	2015/05/18				
CHECKED	-	-				
	-	-				
	-	-				
THIRD ANGLE PROJECTION			TITLE			
			HARDWARE KIT			
SIZE	DWG. NO.		REV			
A	67212		A.			
DO NOT SCALE DRAWING			SCALE 1:2		SHEET 1 OF 1	