

THIS DRAWING AND THE INFORMATION CONTAINED WITHIN IT ARE CONFIDENTIAL AND MAY NOT BE COPIED OR DISCLOSED WITHOUT THE WRITTEN PERMISSION OF LITTELFUSE.

| REV. | | REVISIONS | | |
|------|--------------------------------|-----------|-------------|----------|
| REV. | DESCRIPTION | DATE | DESIGNED | APPROVED |
| A | First issue of outline drawing | 02-Dec-20 | L.Dal Molin | M.Tinto |
| B | Note added | 26-Mar-21 | L.Dal Molin | M.Tinto |

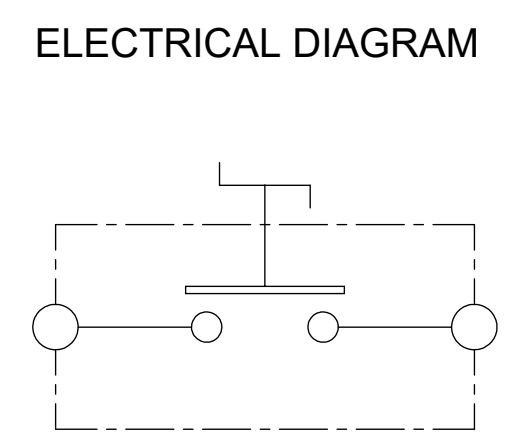
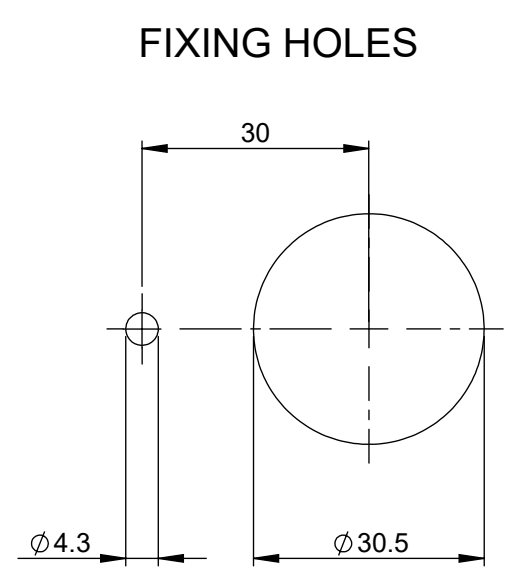
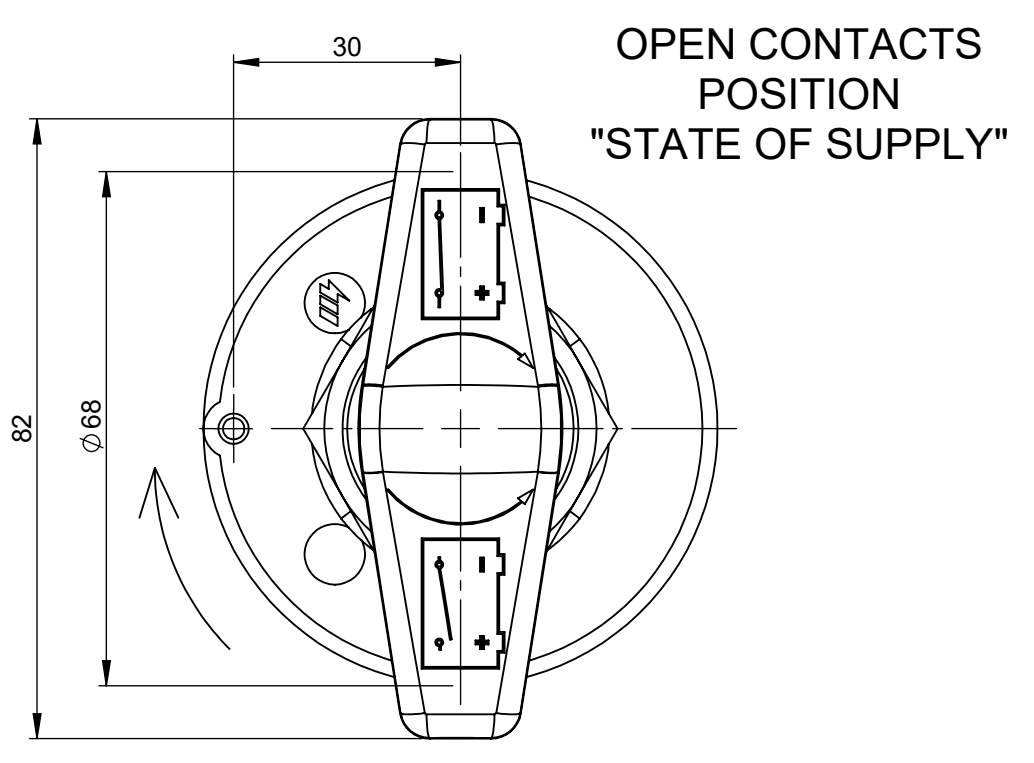
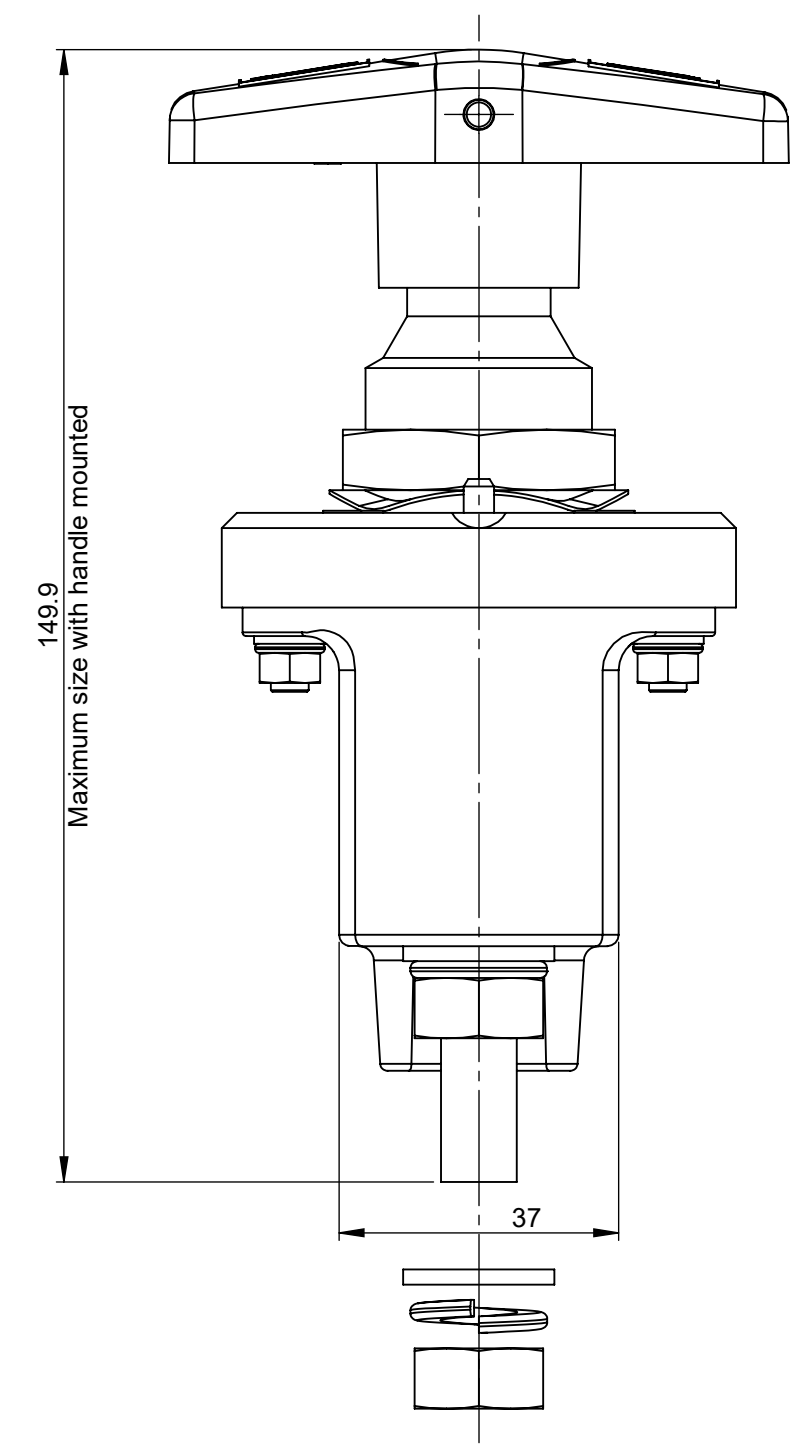
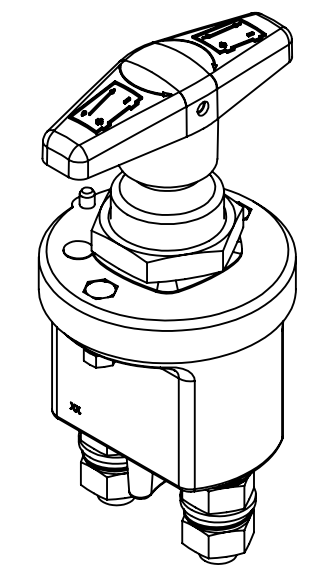
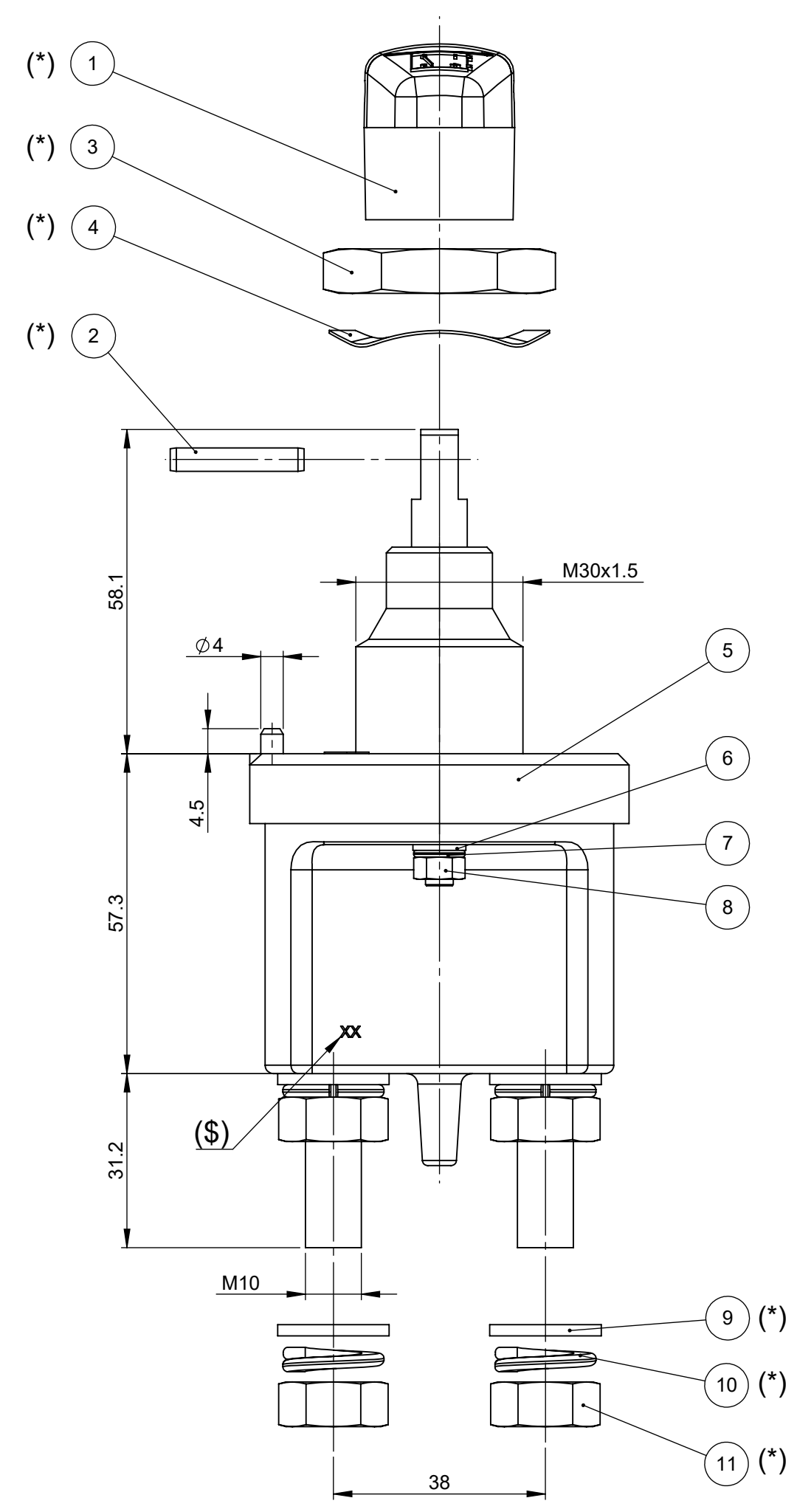

| POS. | P/N | DESCRIPTION | MATERIAL | Q.TY | U/M |
|------|-----|-------------------------|-----------|------|-----|
| 11 | | Nut M10 | Brass | 2 | EA |
| 10 | | Spring washer To 10 | Steel | 2 | EA |
| 9 | | Plane washer Te 10.5x20 | Steel | 2 | EA |
| 8 | | Nut M5 | Steel | 2 | EA |
| 7 | | Spring washer To 5 | Steel | 2 | EA |
| 6 | | Plane washer Tc 5.3x9.5 | Steel | 2 | EA |
| 5 | | Complete IGC | | 1 | EA |
| 4 | | Elastic ring | Steel | 1 | EA |
| 3 | | Nut M30x1.5 | Brass | 1 | EA |
| 2 | | Spiral spring pin | Steel | 1 | EA |
| 1 | | Handle | Aluminium | 1 | EA |

PRESCRIPTIONS

- Contacts lock by 90° clockwise rotation of handle
- (\$) Marking of manufacturing date, indifferently on right or left terminal
- (*) Handle, spiral spring pin, nut M30x1.5, elastic ring, nuts and washers supplied in the kit

CHARACTERISTICS

- Max operating voltage: 24 DC
- Max continuous current: 250A & 350A
- Intermittent current: 2500A at 3 sec.
- Handle operating torque: 2(±0.5) Nm
- M10 nut closing pair: 19(±3) Nm
- M5 nut closing pair: 1.5(±0.5) Nm
- Locking nut M30x1.5: 35(±5) Nm
- Maximum thickness lockable with nut M30: 12mm
- ⓑ - Handle operating torque: 2±0.5 Nm

SAP drawing number: 10000098930

Material and treatments:

| DIMENSIONS AND TOLERANCES IN MILLIMETERS, DEFINED ACCORDING TO ISO 1101-2017. | |
|---|---|
| linear dimensions | |
| 0,5 3 | >3 6 |
| ±0,2 | ±0,3 |
| angle (for range of lengths) | |
| up to 10 | >10 50 |
| ±1°30' | ±1° |
| <p>● FIT/ FUNCTION CRITICAL CHARACTERISTICS SYMBOL</p> <p><S> SAFETY/ COMPLIANCE CRITICAL CHARACTERISTICS SYMBOL</p> <p>CPK DENOTES CPK DIMENSIONS MINIMUM CPK VALUE</p> <p>ST DENOTES A CHARACTERISTIC THAT PROVIDES AN INDICATION OF PROCESS PERFORMANCE. PROCEDURE FOR MEASUREMENT AND TRACKING TO BE DEFINED IN LITTELFUSE INSPECTION INSTRUCTIONS</p> <p>CP DENOTES CP DIMENSIONS. MINIMUM CP VALUE MUST BE WITHIN THE DIMENSIONAL LIMITATIONS SHOWN ON DRAWING AND INITIALLY LOCATED TO ALLOW FOR MAXIMUM TOOL LIFE</p> | |
| NAME | DATE |
| DRAWN L. Dal Molin | 22-Jan-21 |
| CHECKED | |
| <p>Expertise Applied Answers Delivered</p> | |
| FORM NO. CVP-PE40-0013 REV A | TITLE |
| FIRST ANGLE PROJECTION | 250A MANUAL BATTERY MASTER SWITCH WITH FIXED HANDLE |
| SIZE: A2 | DWG. NO. OL-08099166 |
| DO NOT SCALE DRAWING | SCALE 1:1 |
| | SHEET 1 OF 1 |