

LTR	DATE	REVISION	DRW
A	20/JAN/20	521900GCA - RELEASE	OPL

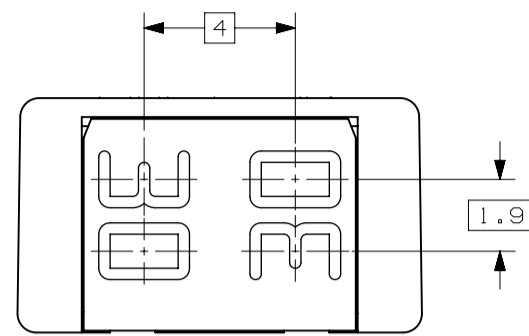

OCR MARKING FOR 15-30A FUSES

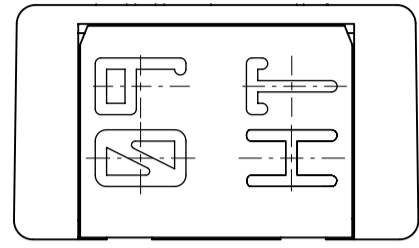

OCR MARKING FOR 40-60A FUSES

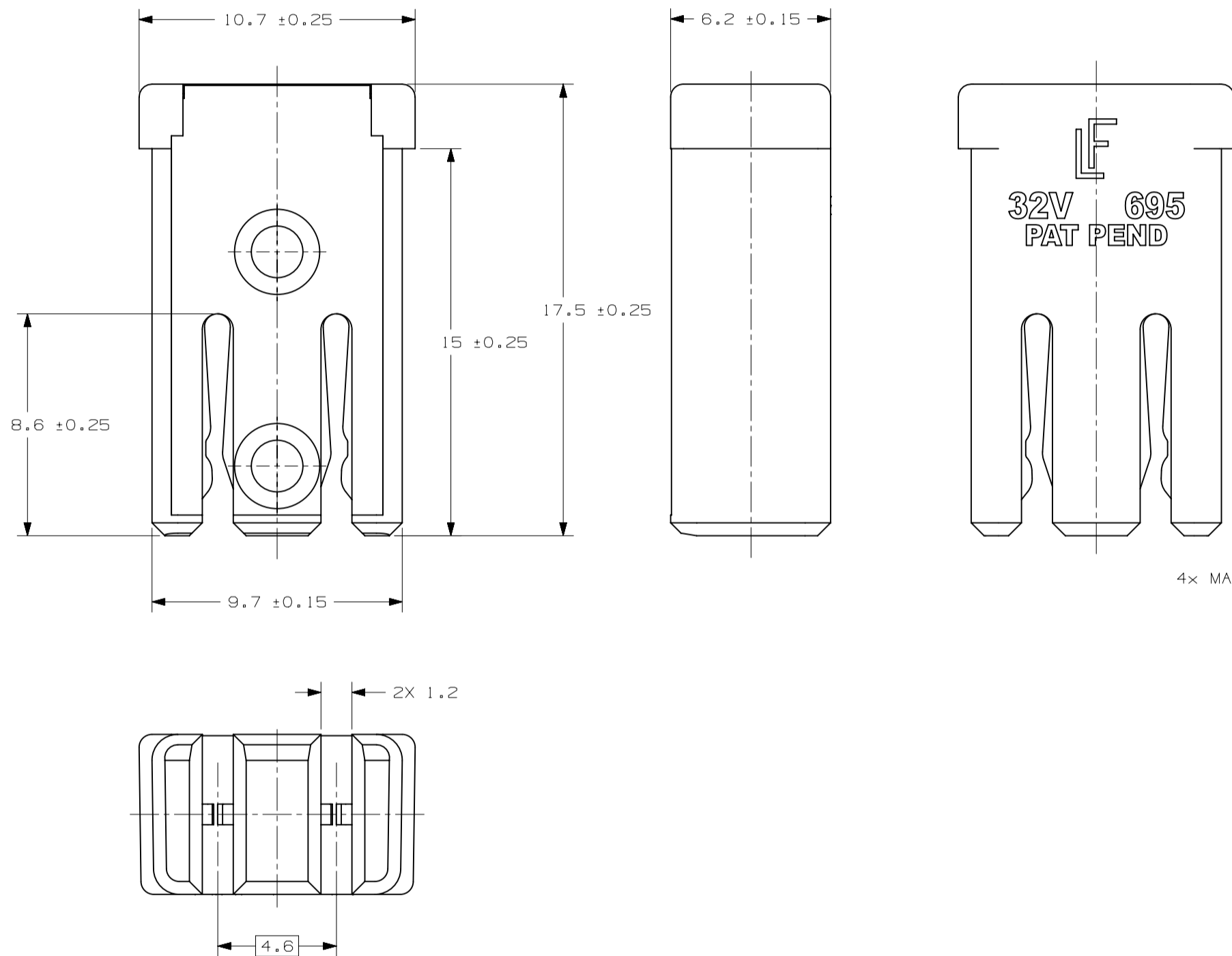

LITTELFUSE NOTES:

- MATING MALE BLADE PARAMETERS:
BLADE WIDTH - 6.2mm MIN
BLADE THICKNESS - 0.8+0.04/-0.03mm.
BLADE LENGTH - 8.0±0.4mm.
BLADE CENTERLINE SPACING - 4.6±0.1mm.
- INTERRUPTING RATING - 1000A @32VDC.
- CURRENT RATING TO BE MARKED IN BLACK ON TOP OF PART.
- RATING STAMP MARKED WITH CHARACTERS 2.4 X 1.5mm.

RENAULT NOTES:

- REALISATION AND SUPPLY OF PRODUCT ACCORDING TO STANDARD 00-10-415--T
- PROHIBITED OR RESTRICTED SUBSTANCE ACCORDING TO STANDARD RNE5 B00027 V2.0
- RENAULT ENGINEERING CENTRE TAKES IN TO CONSIDERATION IN THE ABSENCE OF MARKING ACCORDING TO STANDARD 00-10-501--E
- FUSE COMPLIES TO THE RSA STANDARD CDC-36-05-205

PART NO. LITTELFUSE	CURRENT RATING (A)	MAX. VOLTAGE RATING (VDC)	MAX. VOLTAGE DROP @ 100% I _r (mV)	HOUSING COLOR	FUNCTIONAL PART NO. RENAULT	PART NO. RENAULT
0695015.PXPS	15	32	125	GREY	294107467R	294106273R
0695020.PXPS	20	32	125	BLUE	294107984R	294106147R
0695025.PXPS	25	32	125	WHITE	294107618R	294105695R
0695030.PXPS	30	32	120	PINK	294105553R	294109621R
0695040.PXPS-HT	40	32	120	GREEN	294105862R	294109162R
0695050.PXPS-HT	50	32	120	RED	294109376R	294100322R
0695060.PXPS-HT	60	32	120	YELLOW	294104102R	294102257R

ISO GPS
TOLERANCEMENT DIMENSIONNEL, GEOMETRIQUE ET D'ETAT DE SURFACE SELON ISO 8015:2011 CONFORMEMENT A LA NORME RENAULT 00-10-039--A

DIMENSIONAL, GEOMETRICAL AND SURFACE TEXTURE TOLERANCING AS PER ISO 8015:2011 IN ACCORDANCE WITH RENAULT STANDARD 00-10-039--A

TAILLE ISO 14405 OUI/YES
SIZE ISO 14405 NON/NO

ISO 10579-NR COTATION ET TOLERANCEMENT DE PIECE NON RIGIDE SUIVANT ISO 10579:2010
ISO 10579-NR DIMENSIONING AND TOLERANCING OF NOT RIGID PART ACCORDING TO ISO 10579:2010

OUI/YES (1)
 NON/NO

(1) ASSUREZ VOUS QUE LES CONDITIONS DE CONTRAINTE A APPLIQUER SONT SPECIFIEES
MAKE SURE THAT THE RESTRAINED CONDITIONS TO BE APPLIED ARE SPECIFIED

HIERARCHISATION DES CARACTERISTIQUES NORME 01-33-301
CLASSIFICATION OF REQUIREMENTS STANDARD 01-33-301

TOTALE TOTAL

TOUTE CARACTERISTIQUE NON HIERARCHISEE EST DE NIVEAU 3
ANY CHARACTERISTIC NOT CLASSIFIED BELONGS TO LEVEL 3

CONFORMEMENT A LA NORME 01-00-510 --H
LISTE VISAMAT ANNEXE 1
CONSISTENTLY WITH 01-00-510 --H STANDARD VISAMAT LIST IN APPENDIX 1

PLAN SOUMIS A LA SIGNATURE
DRAWING SUBJECTED TO SIGNATURE

PLAN NON SOUMIS A LA SIGNATURE
DRAWING NOT SUBJECTED TO SIGNATURE

LIAISONS ELECTRIQUES NORME 01-58-904
ELECTRICAL CONNECTIONS TO STANDARD 01-58-904

EN LIAISON AVEC NORME AFFECTED BY STANDARDS

SANS LIAISON AVEC NORME NOT AFFECTED BY STANDARDS

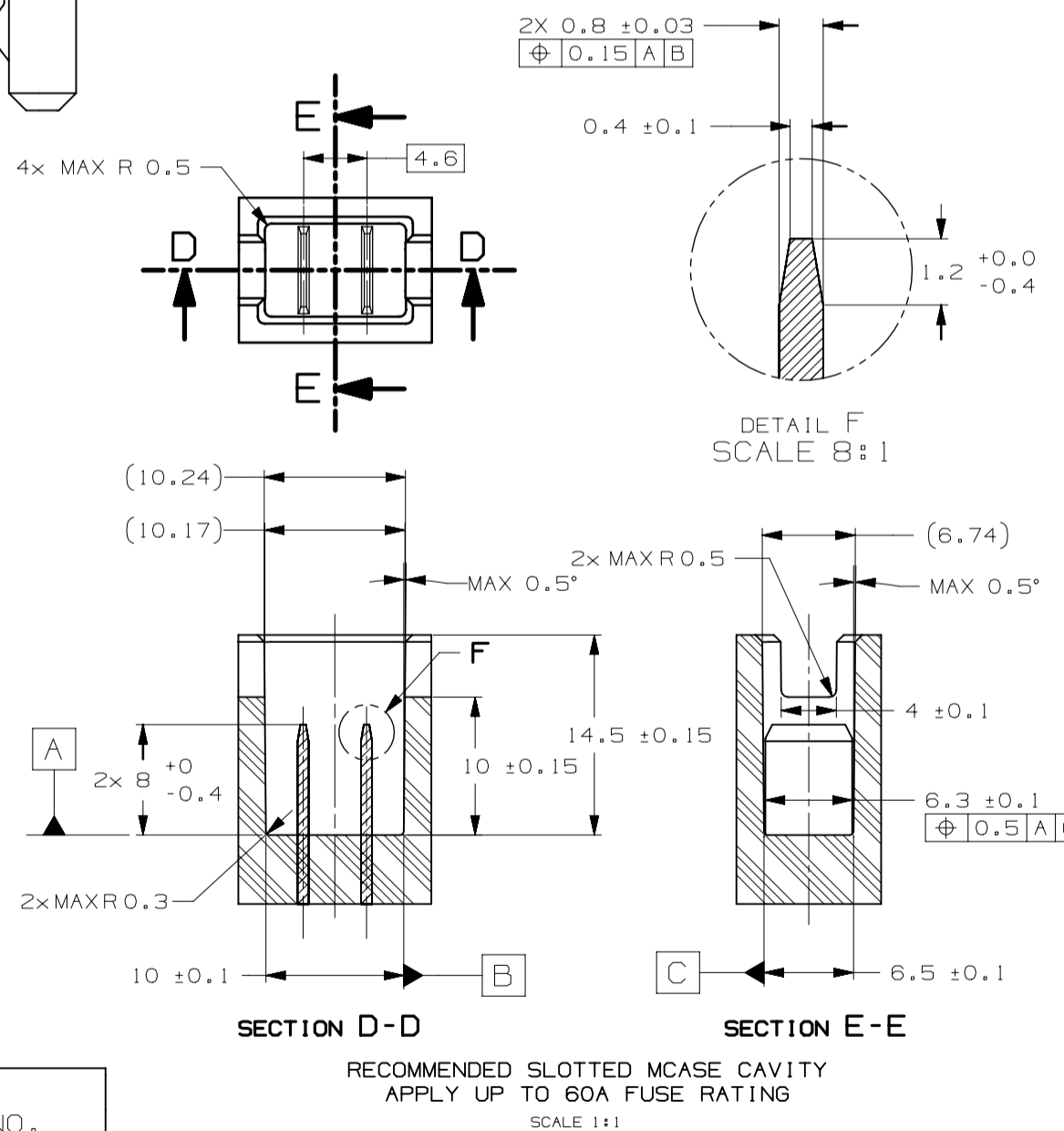

RECOMMENDED SLOTTED MCASE CAVITY APPLY UP TO 60A FUSE RATING SCALE 1:1

OVERLOAD CONDITION (% OF RATED CURRENT)	OPENING TIME (s)	
	MINIMUM	MAXIMUM
110	100 HOURS	-
135	60	1800
200	2	60
350	0.2	7
600	0.04	1

UNLESS OTHERWISE SPECIFIED, DIMENSIONS ARE IN MILLIMETERS. DUAL DIMENSIONS IN BRACKETS [] ARE INCHES AND FOR REFERENCE ONLY.

UNLESS OTHERWISE SPECIFIED, DIMENSIONS DO NOT INCLUDE PLATING.

	CRITICAL CHARACTERISTIC FOR PART SAFETY/COMPLIANCE.
	CRITICAL CHARACTERISTIC FOR PART FIT/FUNCTION.
CPK	CPK DIMENSION. 1.67 MINIMUM CPK VALUE ON NEW TOOLING.
	STATISTICAL PROCESS CONTROL DIMENSION. THIS DIMENSION INDICATES PROCESS PERFORMANCE. DATA SHALL BE TRACKED AND ANALYZED AT PERIODIC TIMES, ACC. TO CONTROL PLAN.
CP	CP DIMENSION. 1.67 MINIMUM CP VALUE. MUST BE INITIALLY LOCATED TO ALLOW FOR MAXIMUM TOOL LIFE.
	CUSTOMER-DESIGNATED CHARACTERISTIC. REQUIREMENT FOR EACH SYMBOL TO BE DEFINED IN A CONVERSION TABLE.
	CLAMP DIMENSION. PARTS SHALL BE SECURED BEFORE TAKING DIMENSIONAL MEASUREMENTS. FIXTURING DATUMS & PROCEDURES TO BE DEFINED IN NOTES OR SEPARATE PROCESS DOCUMENTS.
DIMENSIONS & TOLERANCES ACC. TO ASME Y14.5-2009	MATL SPEC HOUSING: PA66-GF33 COVER: PA66 TERMINAL: Cu ALLOY
3RD ANGLE PROJECTION	FINISH N/A
SCALE 5:1	DRW OPL CHK OMA DATE 20/JAN/20
TOLERANCES UNLESS OTHERWISE SPECIFIED	
LINEAR DIMENSIONS	
DIM	UP TO .5 - 6 ±0.1
TOL	OVER 6 - 30 ±0.2
	OVER 30 - 120 ±0.3
	OVER 120 - 400 ±0.5
	UP TO 400 ±0.5
ANGLES	±0.5°
RADII	±0.2
TITLE SLOTTED MCASE+ & HT (RENAULT)	
REVISION A	
DRWG. NO. 0L-0695000.PXPS&HTRN	

METRIC ASSEMBLY

Littelfuse CHICAGO, USA 773-628-1000