

# 281/556/557 Series

## Thru-Hole Circuit Board Mount Blocks for Micro™/TR-3 Fuses



### Product Characteristics

Compatible Fuses	281 Series Vertical	281 Series Horizontal	556 Series Vertical	557 Series Horizontal
	<b>MICRO™/TR3®</b>			
<b>Description</b>	Thru-hole circuit board mount blocks designed for Littelfuse MICRO™/TR3 type and other fuse series with .025" diameter leads rated to 5 amps			
<b>Electrical</b>	Rated at 5A / 1.6W to 125 volts.			
<b>Mounting Method</b>	PC Board Thru-Hole @ 5.08 hole spacing			
<b>Mount Color &amp; Direction</b>	White Vertical	White Horizontal	Black Vertical	Black Horizontal
<b>Molded Part Specs</b>	White Thermoplastic UL 94V0 PBT		Black Thermoplastic UL 94V0	
<b>Metal Parts and Terminals</b>	Copper Alloy with options Tin Plating (281008, 281010) or Silver Plating (281005, 281007)		Copper Alloy with Tin Plating	
<b>Ambient Temperature</b>	-40°C to +100°C.			
<b>Unit Weight</b>	0.41g	0.50g	0.42g	0.51g

### Additional Information



Resources  
281 Series



Resources  
556 Series



Resources  
557 Series



Accessories  
281 Series



Accessories  
556 Series



Accessories  
557 Series



Samples  
281 Series



Samples  
556 Series



Samples  
557 Series

### Agency Approvals

Agency	Agency File Number		
	281 Series	556 Series	557 Series
	E14721	N/A	N/A

### Ordering Information

Ordering Number	Terminal Plating	Mount Color	Mount Direction	Packaging
02810005H	Silver <sup>1</sup>	White	Vertical	100 (Bulk pack)
02810008H	Tin <sup>1</sup>	White	Vertical	100 (Bulk pack)
02810007H	Silver <sup>1</sup>	White	Horizontal	100 (Bulk pack)
02810010H	Tin <sup>1</sup>	White	Horizontal	100 (Bulk pack)
55600000001*	Tin	Black	Vertical	1000 (Bulk pack)
55700000001*	Tin	Black	Horizontal	1000 (Bulk pack)

1. UL recognized.

\* RoHS compliant.

**Note:** 281 Series meets with Glow Wire requirements specified on IEC 60695-2-12 & 60695-2-13

**Disclaimer Notice** - Information furnished is believed to be accurate and reliable. However, users should independently evaluate the suitability of and test each product selected for their own applications. Littelfuse products are not designed for, and may not be used in, all applications. Read complete Disclaimer Notice at: [www.littelfuse.com/disclaimer-electronics](http://www.littelfuse.com/disclaimer-electronics).



### Dimensions units in inch (mm)

**02810005H, 02810008H**  
White / Vertical Mount Devices

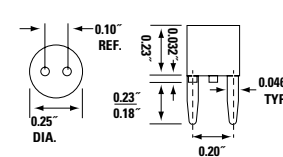

Circuit Board Mounting Detail

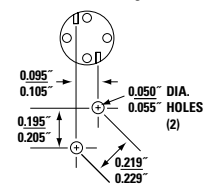

**02810007H, 02810010H**  
White / Horizontal Mount Devices

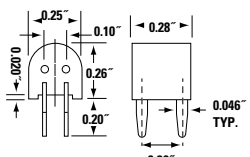

Circuit Board Mounting Detail

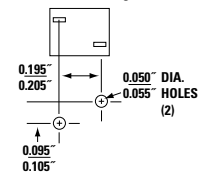

**55600000001**  
Black / Vertical Mount Devices

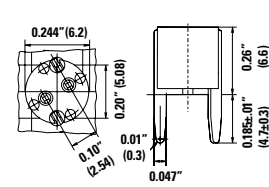

Circuit Board Mounting Detail

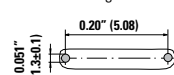

**55700000001**  
Black / Horizontal Mount Devices

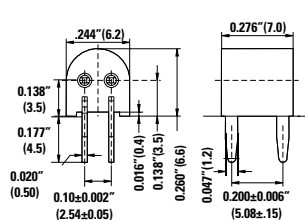

Circuit Board Mounting Detail

