

# POWR-GARD® Fuse Datasheet

## CNN / CNL SERIES LIFT TRUCK FUSES

32/48 V dc • Fast-Acting and Very Fast-Acting • 10–800 A



### Description

CNN fast-acting and CNL very fast acting fuses are recommended for use on battery operated lift trucks and other low voltage battery operated equipment.

### Features/Benefits

- Window shows fuse status
- Up to 2,500 A interrupting rating
- Compact size saves space
- RoHS compliant and lead (Pb) free

### Applications

- Lift trucks
- Scissor lifts
- Pallet movers
- Low voltage battery powered equipment

### Dimensions inches (mm)

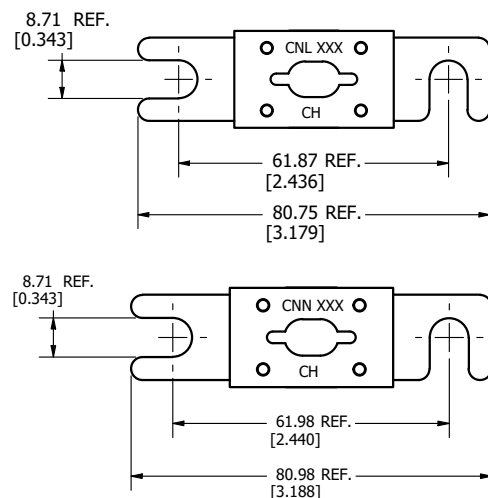

### Specifications

<b>Voltage Ratings</b>	CNN: 48 V dc / 125 V ac CNL: 32 V dc / 32 V ac
<b>Ampere Ratings</b>	10 – 800 A*
<b>Max. Interrupting Rating</b>	2,500 A
<b>Approval</b>	UR (File E71611)
<b>Environmental</b>	RoHS Compliant, Lead (Pb) Free
<b>Country of Origin</b>	China

\*See ordering information table for available amperages by series

### Ordering Information

AMPERE RATINGS CNN (48 V DC)					
10	60	125	225	325	600
35	80	150	250	350	700
40	90	175	275	400	800
50	100	200	300	500	—

AMPERE RATINGS CNL (32 V CDC)				
35	80	150	250	350
40	100	175	275	400
50	125	200	300	500
60	130	225	325	—

SERIES	TYPE	VOLT DC	AMP	CATALOG NUMBER	ORDERING NUMBER
CNN	VERY FAST-ACTING	48	125	CNN125	0CNN125.V
CNL	FAST-ACTING	32	50	CNL050	0CNL050.V

### Web Resources

48 V dc: [Littelfuse.com/cnn](http://Littelfuse.com/cnn)

32 V dc: [Littelfuse.com/cnl](http://Littelfuse.com/cnl)

### Recommended Fuse Block

LFFB0003Z - [Littelfuse.com/lffb](http://Littelfuse.com/lffb)

**Disclaimer Notice** – Information furnished is believed to be accurate and reliable. However, users should independently evaluate the suitability of and test each product selected for their own applications. Littelfuse products are not designed for, and may not be used in, all applications. Read complete Disclaimer Notice at [www.littelfuse.com/product-disclaimer](http://www.littelfuse.com/product-disclaimer).